

WHERE EVENTS
COME TO
LIFE

ADNEC
VENUES



adnec
centre
abu dhabi
مركز أدنيك أبوظبي

adnec
centre
مركز أدنيك العين
al ain

Part of ADNEC GROUP

ADNEC Venues

A world-class venue operator, ADNEC Group owns and operates four multi-award winning international venues in Abu Dhabi and London.



adnec
centre
abu dhabi
مركز أدنيك أبوظبي

ADNEC Centre Abu Dhabi

ADNEC Centre Abu Dhabi is the largest venue in the Middle East. Located in Abu Dhabi, the capital of the United Arab Emirates, ADNEC Centre Abu Dhabi offers organisers of exhibitions, conferences and corporate events an impressive 153,678 square metres (1,654,176 sq feet) of flexible event space.



adnec
centre
مركز أدنيك العين al ain

ADNEC Centre Al Ain

Also situated in the Emirate of Abu Dhabi is the ADNEC Centre Al Ain. This exceptional venue hosts exhibitions, conferences and other special events. It is built in a unique architectural style that is in harmony with the city's existing architecture with a marquee-style roof. It offers 11,900 square metres (128,092 square feet) of exhibition and conference space.

ADNEC Venues

A world-class venue operator, ADNEC Group owns and operates four multi-award winning international venues in Abu Dhabi and London.



excel
لندن LONDON

ExCeL London

ADNEC Group owns and operates the 100,000sqm ExCeL London, London's largest event venue located in London's docklands area. The newly expanded venue hosts some of London's most prestigious events. ExCeL is also home to Immerse London, the UK's largest immersive entertainment district, showcasing world-class immersive experiences as well as a wide variety of food and beverage offerings.



**BUSINESS
DESIGN
CENTRE**

Business Design Centre

Business Design Centre situated in London's Islington is a multi-purpose trade centre with flexible spaces for conferences, exhibitions and events offering organisers 6,000sqm of event space. The Business Design Centre welcomes over 900k visitors a year.

adnec centre

مركز أدبيك أبوظبي abu dhabi

ADNEC Centre Abu Dhabi is the largest venue in the Middle East. Located in Abu Dhabi, the capital of the United Arab Emirates, ADNEC Centre Abu Dhabi is a multi-award winning venue, offering organisers of exhibitions, conferences and corporate events an impressive 153,678 square metres (1,654,176 sq feet) of flexible event space.

Abu Dhabi is uniquely positioned so that half of the world's population is within a five hour flight time. Guaranteed sunshine all year round, a reputation as the safest city in the world along with a growing knowledge economy and numerous attractions are all helping Abu Dhabi to emerge as a popular business and tourism hub in the region.

WHERE EVENTS COME TO LIFE.



The background of the entire page is a collage of event photos. The top left shows a stage with blue spotlights. The middle left shows a large audience seated in a conference hall. The middle right shows a white SUV on a stage with a large golden projection behind it. The bottom right shows a close-up of an audience member in a white thobe.

CONFERENCES

EXHIBITIONS

**CORPORATE
EVENTS**

MEETINGS

BRINGING YOUR EVENTS TO LIFE

ADNEC Centre Abu Dhabi hosts some of the world's leading business and consumer events. From the methodical to the magical, there is no better platform in the Middle East to set your imagination free and deliver lasting memories for all those involved.

**GALA
DINNERS**

WEDDINGS

**SPECIAL
EVENTS**

BRINGING YOUR EVENTS TO LIFE

ADNEC Centre Abu Dhabi hosts some of the world's leading business and consumer events. From the methodical to the magical, there is no better platform in the Middle East to set your imagination free and deliver lasting memories for all those involved.



THE WORLD WITHIN YOUR REACH

One of the most accessible venues in the world, ADNEC Centre Abu Dhabi is just 15 minutes away from the rapidly expanding Zayed International Airport, 20 minutes from downtown Abu Dhabi and 60 minutes from Dubai.



Airports and airlines:

Zayed International Airport	+100 destinations, +50 airlines
Dubai International Airport	+260 destinations, 140 airlines
Al Maktoum International Airport	+44 destinations, 27 airlines



Driving times to ADNEC:

Zayed International Airport	15 minutes
Al Maktoum International Airport	60 minutes
Dubai International Airport	90 minutes

Taxis are widely available at all airports, and transfers can easily be pre-booked through Tourism 365, contact the team to book:

Phone: +971 2 406 3300 | Email: services@tourism365.ae



Andaz Capital Gate Abu Dhabi
★★★★★

Aloft Abu Dhabi
★★★★★

Premier Inn Abu Dhabi Capital Centre
★★★

Capital Centre Arjaan
★★★★★

Centro Capital Centre
★★★

Capital Suites Hotel Apartments
★★★★★

Pearl Rotana Capital Centre
★★★★

AT THE HEART OF CAPITAL CENTRE

ADNEC Centre Abu Dhabi is at the heart of Capital Centre, a purpose built, interconnected event campus. With seven on-site hotels and including the ADNEC owned Andaz Capital Gate Abu Dhabi and Aloft hotels connected to the venue via internal walkways, Capital Centre offers organisers and delegates around 1,800 hotel rooms ranging from three to five stars as well as excellent dining options in easy walking distance. ADNEC Centre Abu Dhabi is also within reach of 138 hotels, offering 34,000+ hotel rooms across the city.

ACCOMMODATION

2,100+

hotel rooms attached to and within walking distance of ADNEC Centre Abu Dhabi

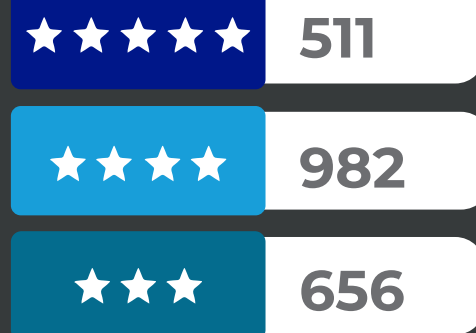

An additional **4,209** hotel rooms within a 15 minute drive.

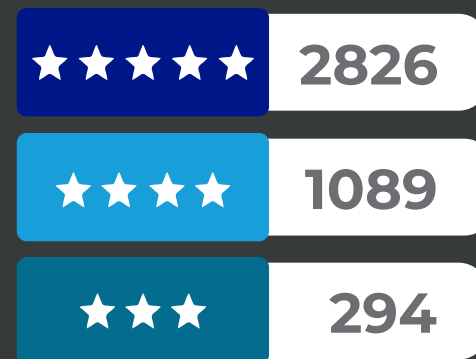

34,000+

3-5 star hotel rooms across the city

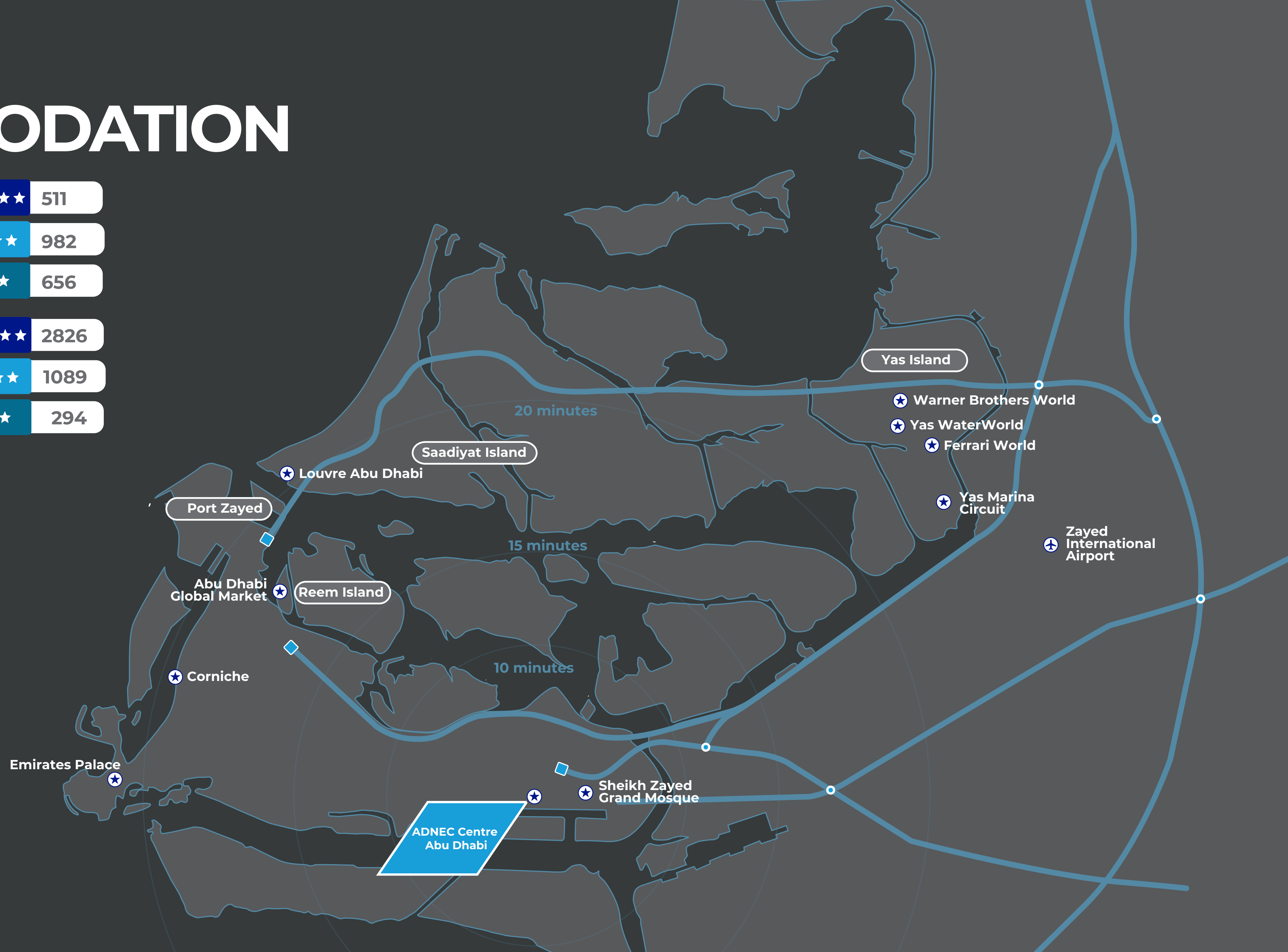
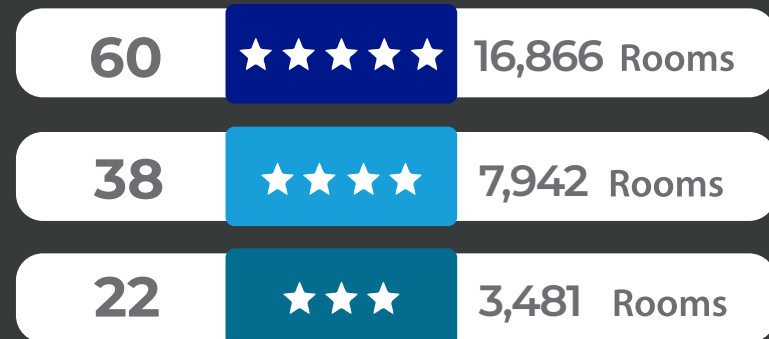

Services and Amenities

The venue has everything you need for a hassle-free experience, leaving you to make the most of your event. Whether it's an excellent cup of coffee you're after, freight services, or car hire, we have got you covered.



**7,000
parking
spaces**



Transportation



**Onsite
Catering**



Retail



**Postal &
freight
Service**



**Travel
Agency**

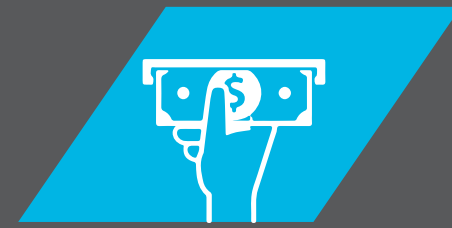

ATM



Pharmacy



Marketing Support

Our marketing team is dedicated to ensuring the success of every event held at ADNEC Centre Abu Dhabi and to this end, the team provides a number of complimentary services to ensure maximum visibility for your event. Services include PR & social media support, promotion on our large outdoor and indoor digital screens, exposure on our 'what's on' page with a dedicated event page as well as email campaigns. The team can also connect organisers to the Abu Dhabi Calendar team for additional promotional opportunities on an Emirate wide level.

Contact marketing at marketing@adnec.ae



EVENT MANAGEMENT



capital 360
كابيتال 360
event experiences
لتجارب الفعاليات

CATERING SERVICES



capital catering+
كابيتال للضيافة+

PROTOCOL SERVICES



capital protocol
كابيتال بروتوكول

An award-winning event management agency, Capital 360 Event Experiences offers clients a wide range of customised solutions which include Event Management, Creative & Design, Professional Conference Organising, A/V Production, Stand Design & Build, Main Contracting & Sports Management alongside services such as Media, Telecom, Printing, Graphics & Rigging.

Contact the team:
customer.services@adnec.ae

In-house caterer, Capital Catering+ offers mouthwatering and creative, bespoke catering solutions. Our award-winning team can work with you to create memorable menus for your delegates or visitors, whether you are catering for exhibitions, meetings, conferences or creating grand dining experiences.

Contact the team:
sales@capitalcatering.ae

Capital Protocol, provides customised event management and guest management services to high-level delegations, VIPs, and government officials in the UAE. Our team comprises skilled professionals with vast experience in meticulously planning and managing the needs of distinguished guests from all over the world. We work closely with relevant authorities to ensure a seamless and secure experience for our clients.

Contact the team:
protocol@capitalprotocol.ae

DESTINATION MANAGEMENT COMPANY



tourism365
سياحة 365
business & leisure
للأعمال والترفيه

Trouism 365, ADNEC Centre Abu Dhabi's destination management company, makes it easier than ever to arrange your travel bookings and authentic cultural experiences with more than 100 excursion programmes on offer. The team deals with integrated services that cover all your business travel needs, including organising corporate, private functions or social gatherings, providing one-of-a-kind experiences.

Contact the team:
info@capitalexperience.ae

ALOFT ABU DHABI



aloft
ABU DHABI

Aloft Abu Dhabi is the largest Aloft hotel in the Europe, Middle East and Africa region. The four star hotel offers 408 rooms over 12 storeys and is interconnected with ADNEC Centre Abu Dhabi.

Contact the hotel:
filipa.costa@marriott.com

ANDAZ CAPITAL GATE



ANDAZ CAPITAL GATE
ABU DHABI
أنداز كابيتال جيت أبو ظبي

Located in the iconic Capital Gate tower, the five star Andaz Capital Gate hotel provides 188 rooms and unsurpassed views of the city and coastline. The hotel is directly connected to ADNEC Centre Abu Dhabi.

Contact the hotel:
filipa.costa@marriott.com

GIVING YOUR EVENT THE ADVANTAGE



Website

Abu Dhabi Convention and Exhibition Bureau drives and supports the development and promotion of business events throughout the emirate. The team provides co-ordination with local partners, and helps arrange introductions to key Abu Dhabi stakeholders, secures support from mainline industry and tourism leaders, and assists with government liaison, researching appropriate venues, offering PR and marketing support, and providing innovative activities and pre- and post- conference ideas.



Website

The Advantage Abu Dhabi programme provides a unique opportunity for event organisers to gain destination driven value by providing bespoke destination support. Business event organisers with a viable proposal can apply to this initiative for start-up financial grants, government endorsement, leadership patronage, cost rebates and marketing support among others.



ADNEC CENTRE ABU DHABI



Space	Size (sqm)	Size (ft ²)
Indoor Areas	89,638 sqm	964,855 ft ²
Outdoor Areas	64,040 sqm	689,320 ft ²
Total	153,678 sqm	1,654,176 ft²

Space	Seating capacity
ICC Abu Dhabi	Up to 6,000
Conference Halls A & B	Over 1,600 combined
21 meeting rooms	Between 20 and 240
Grandstand	5,400
Hall 4	3,000
The Hive	200
Al Ma'ared	1,394



Click the icon to navigate your favourite spot

President Joko Widodo St



Website

Car Park B

كابيتال جيت
CAPITAL GATE

ANDAZ
CAPITAL GATE
ABU DHABI



Website

The Grandstand

Marina Bridge

Al Khaleej Al Arabi St

Al Khaleej Al Arabi St

KEY

- Information Desk
- Organiser Office
- F&B
- ATM Machine
- Elevator
- Female Prayer Room
- Male Prayer Room
- Toilets
- First Aid
- Security

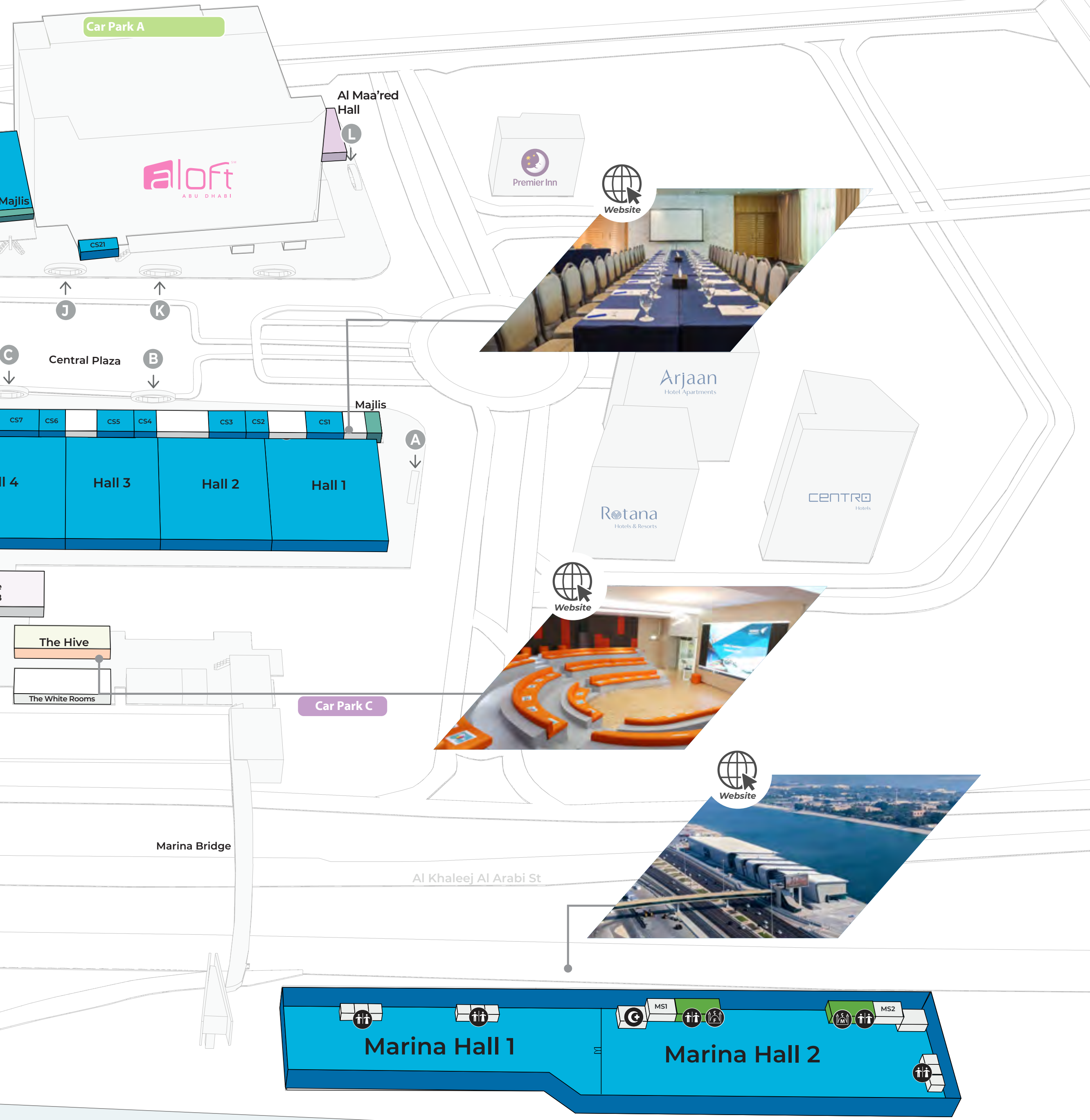

Website

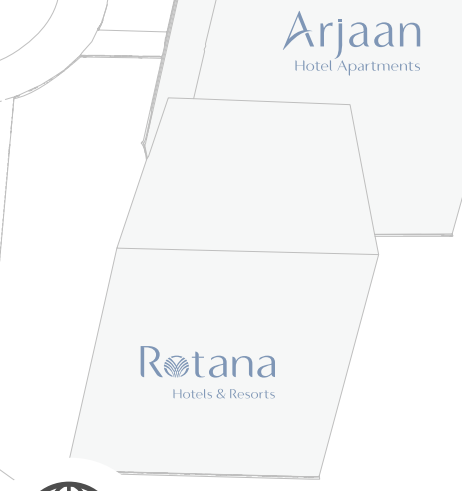

Website



Website



Website

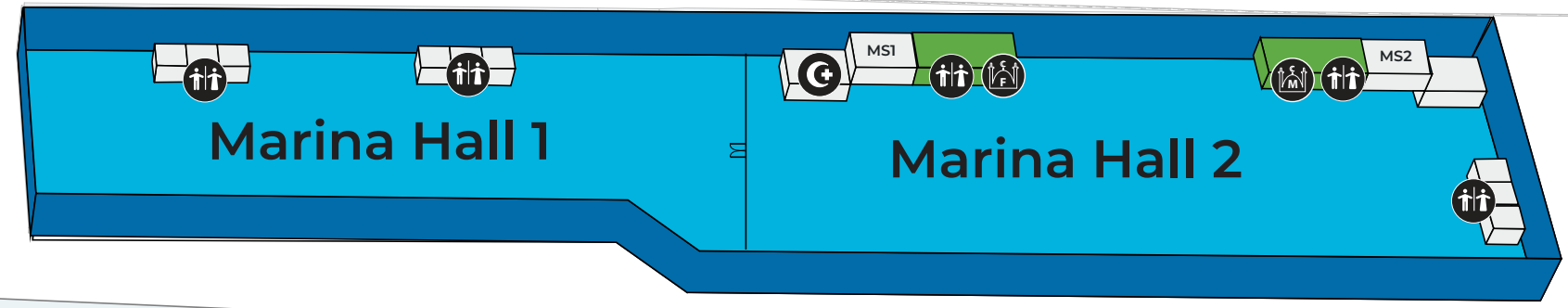

EVENT SPACE

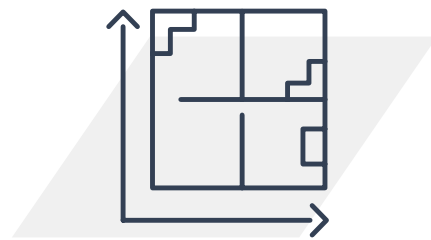

153,678 sqm
(1,654,176 ft²) of
indoor and outdoor
event space

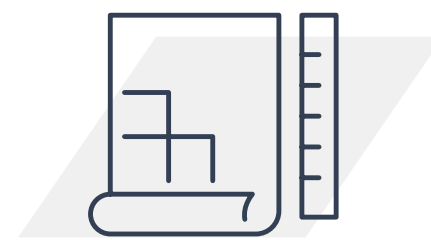

12 interconnected,
partitionable halls
from **3,167** to
7,919sqm

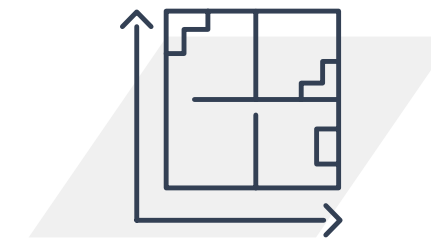

38 vehicle entry
doors from **4.2m**
to **7.75m** height

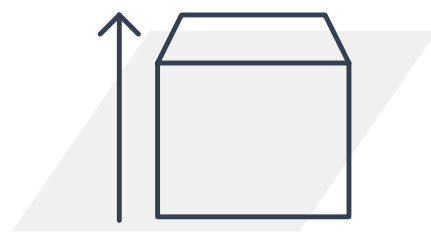

Halls **1** to **11** and
Marina Hall
height of **10m** to
underside of truss

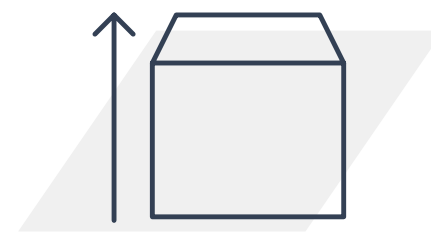

ICC Abu Dhabi
Ceiling Height **13m**

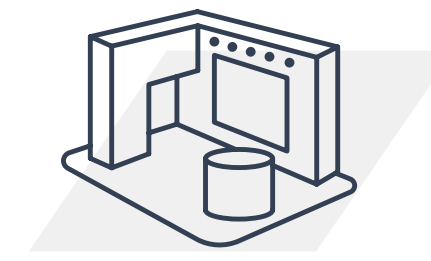

14 organiser
offices from
25 to **102sqm**

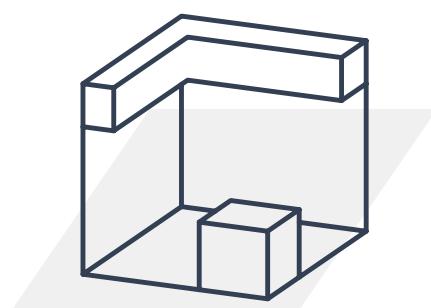

2 conference halls
with combined
capacity of **1,600**



21 meeting rooms
for **20** to **240**
delegates

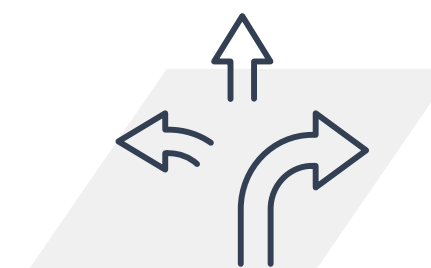

Marina hall is
located on a
main road and
has water access

EVENT SPACE

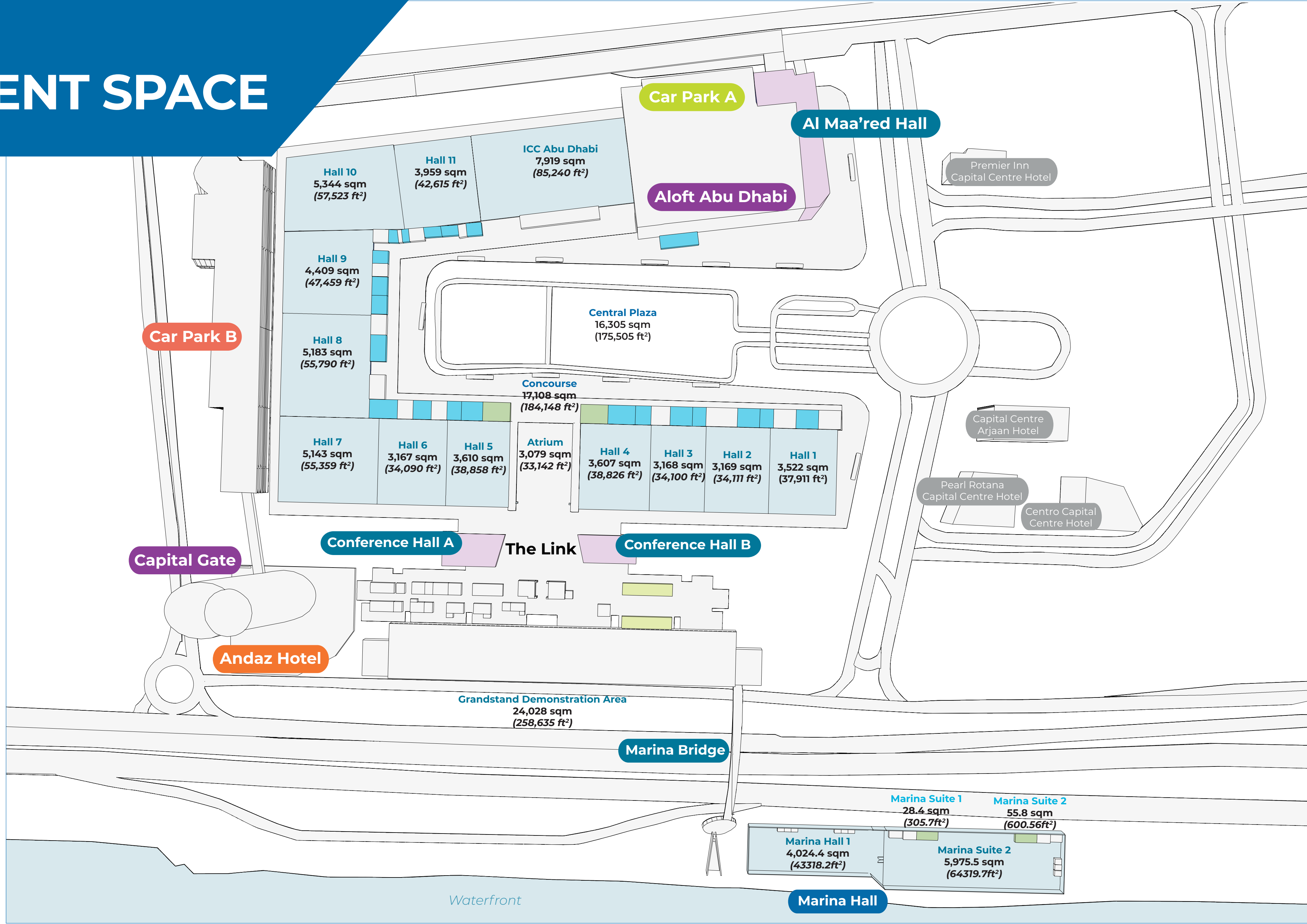

ICC ABU DHABI

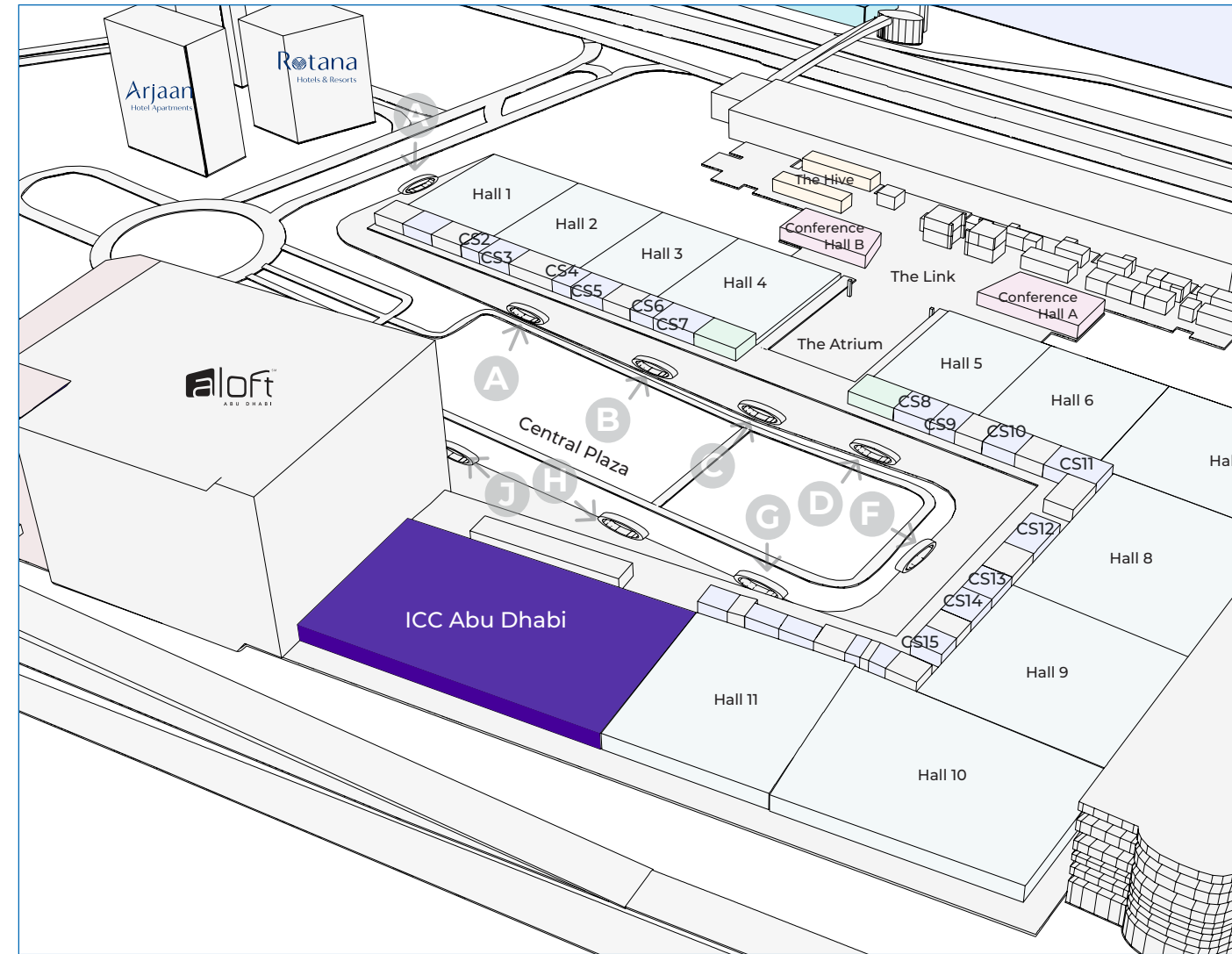

- › A flexible space that can be sectioned into 4 parts.
- › Adjacent exhibition space and catering areas
- › 3 minute walk from Aloft Abu Dhabi Hotel
- › 3 minute walk from multi-storey car park

ICC ABU DHABI

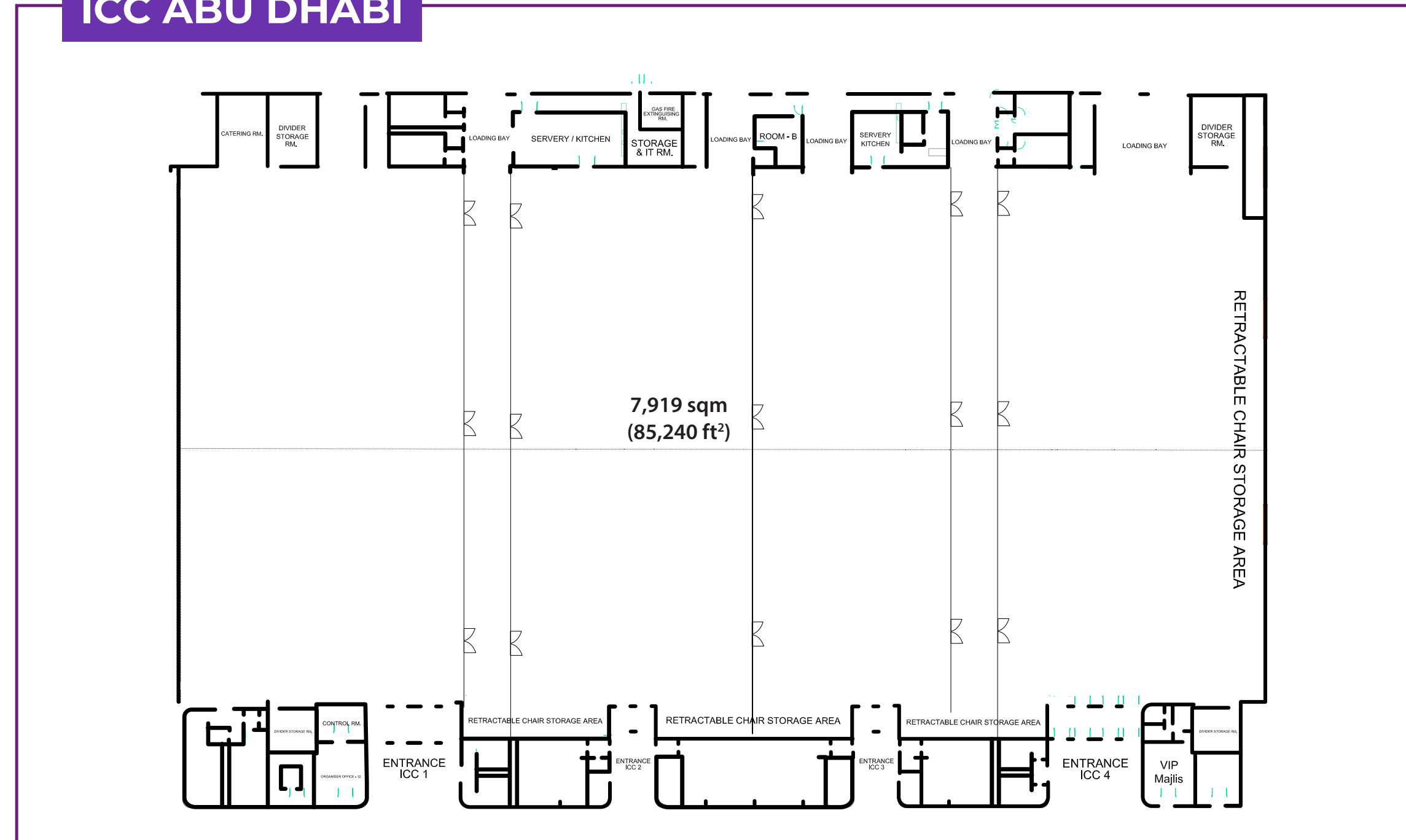

Dimensions		Free Standing & Retractable Seating	
Dimensions	66 x 120 (216 ft ² x 393 ft ²)	Total Seating capacity	6,000
Total floor area	7,919 sqm (85,240ft ²)	Tiered seating	2,671
Ceiling height (Clearance)	13.5 m (44.29 ft ²) finished floor to underside of steel roof truss	Flat floor seating	3,329
	13 m (42.65 ft ²) finished floor to undersides of movable wall tracks	Organiser Offices Area (sqm) Area (ft²)	
		ICC Abu Dhabi	47 506

ICC ABU DHABI



MARINA HALL

Marina Hall is the largest of its kind in the MENA region. Suitable for exhibitions, corporate and special events as well as product launches and activations this unique, versatile space can incorporate activities and showcases both on and off the water. The adjacent 6m deep channel enables a variety of marine vessels to berth alongside, including military ships and super-yachts. The adjacent Marina Waterfront area provides 23,707sqm (255,180.24 sqft) of outdoor event space.

Marina Hall is located on Khaleej Al Arabi Street, allowing easy access from Zayed International Airport and downtown Abu Dhabi with convenient adjacent parking facilities. The space is connected to ADNEC Centre Abu Dhabi via a marina bridge.

Specifications	
Ceiling Height	10m (32.81ft)
Marina Hall 1	4,024.4 m (43318.2ft)
Marina Hall 2	5,975.5 m (64319.7ft)
Total Area	10,000 square metres (107,639 square feet)
Loading Bays	Vehicle Entry door 1: 7.2m x 6m (23.3ft x 19.68ft) Vehicle Entry door 2: 6m x 5.5m (19.68 x 18.04ft)
Prayer Rooms	Male and female prayer rooms
Parking Spaces	700
Marina Suite 1	28.4sqm - 3.2m (305.7ft - 34.44ft)
Marina Suite 2	55.8sqm - 3.2m (600.56ft - 34.44ft)

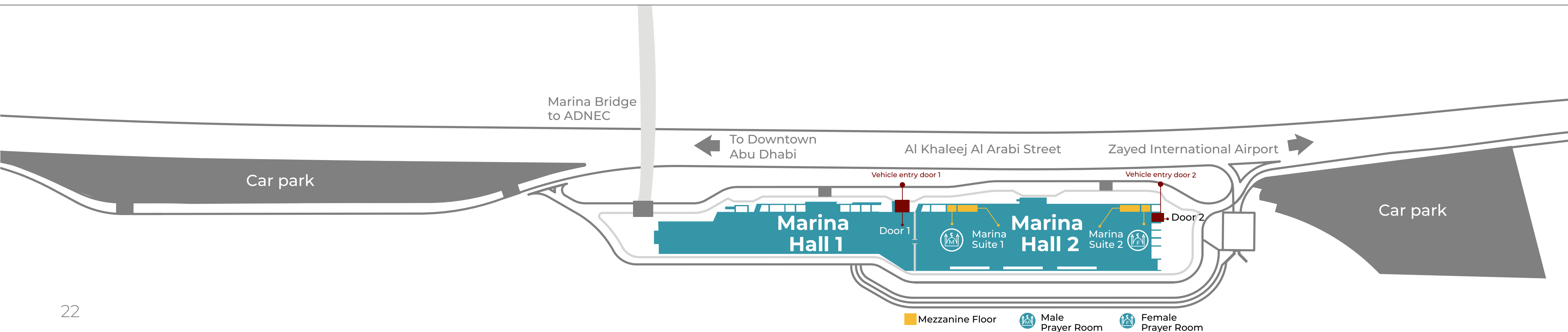



HALL 4

A versatile event solution

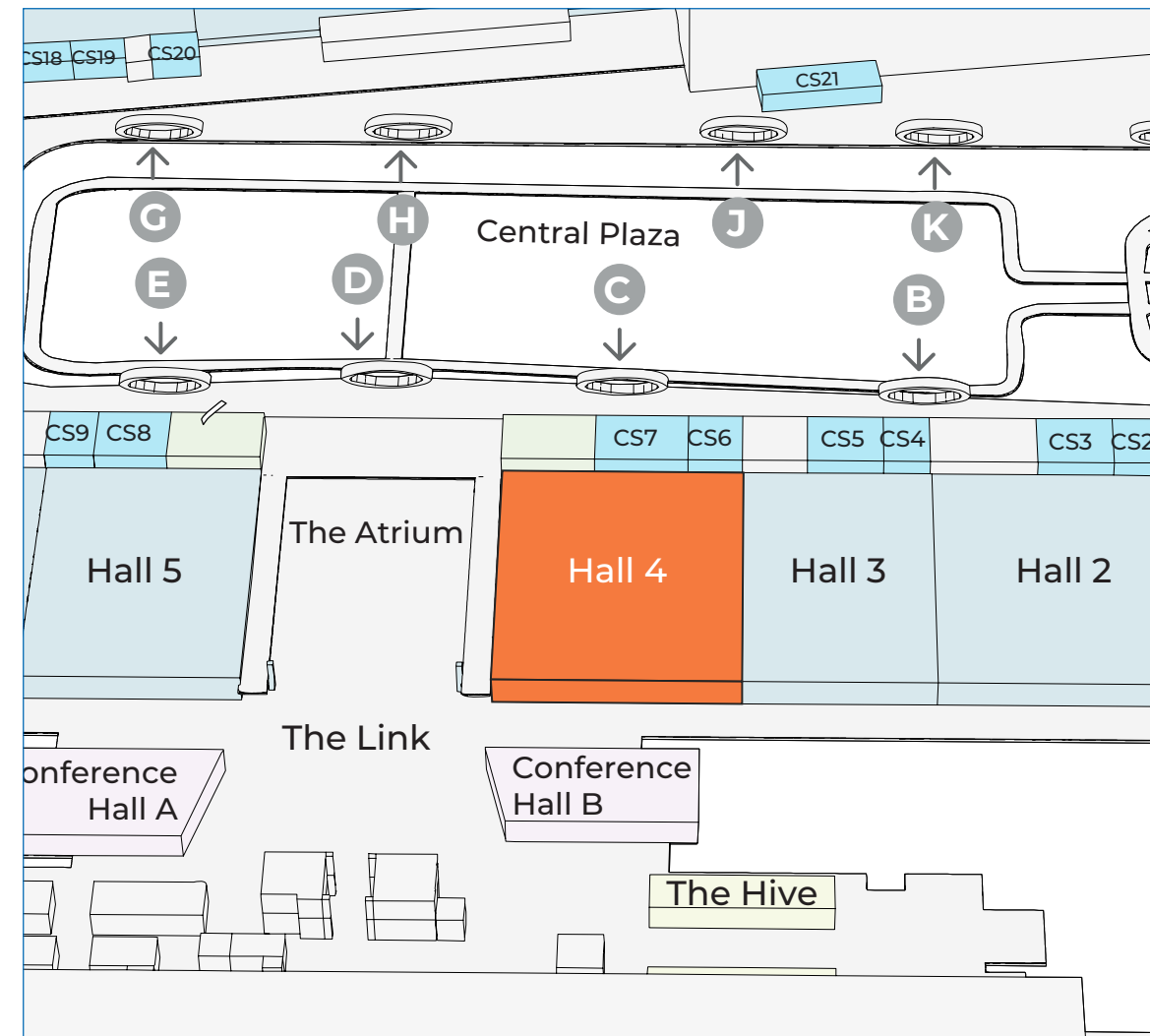

A flexible Space for Corporate Events & Conferences, Hall 4 is a 3,607 sqm (38,826 ft²) capacity space for large events and can be easily sectioned into either two or three standalone spaces. The facility includes three audio systems, microphones and cabling together with three projectors, screens, lighting as well as three stages to ensure that each of the sections has stand-alone capability.

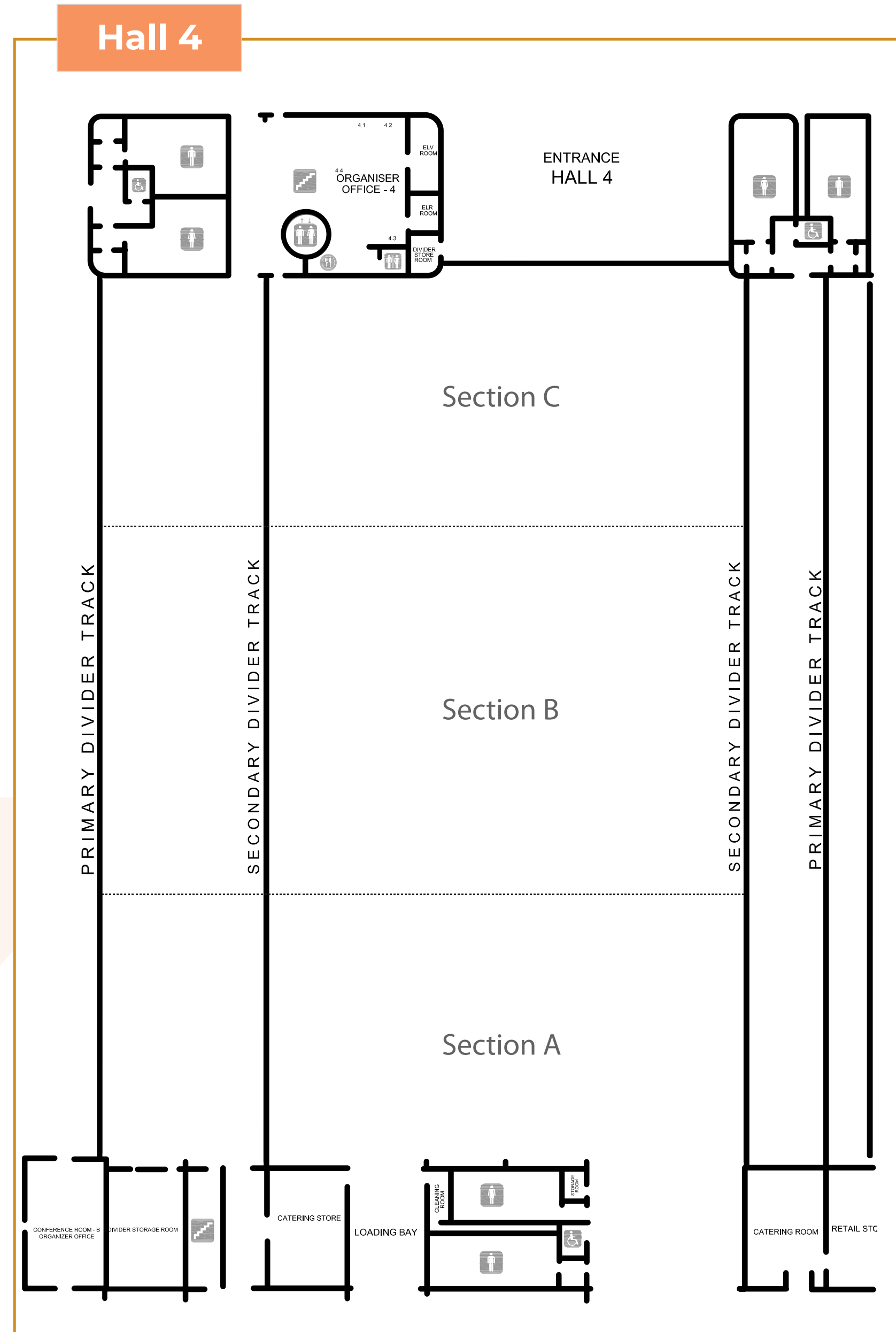

Dimensions

Floor Area 3,607 sqm (38,826 ft²)

Ceiling Height 9.5 m (31.17 ft²)

Capacities

	Max Area	Part A	Part B	Part C
Area (sqm)	3,607	1,081	1,445	1,081
Area (ft ²)	38,826	11,636	15,554	11,636
Cocktail/ Reception	1,832	536	760	536
Theatre Style	3,430	1,000	1,430	1,000
Classroom	1,716	528	660	528
Banquet	1,400	400	600	400

Organiser Offices

	Area (sqm)	Area (ft ²)
Hall 4	57	614

This capacity chart is based on having tables, chairs, and stage only. Any additional item will affect these figures.

HALL 4

A versatile event solution



AL MAA'RED HALL

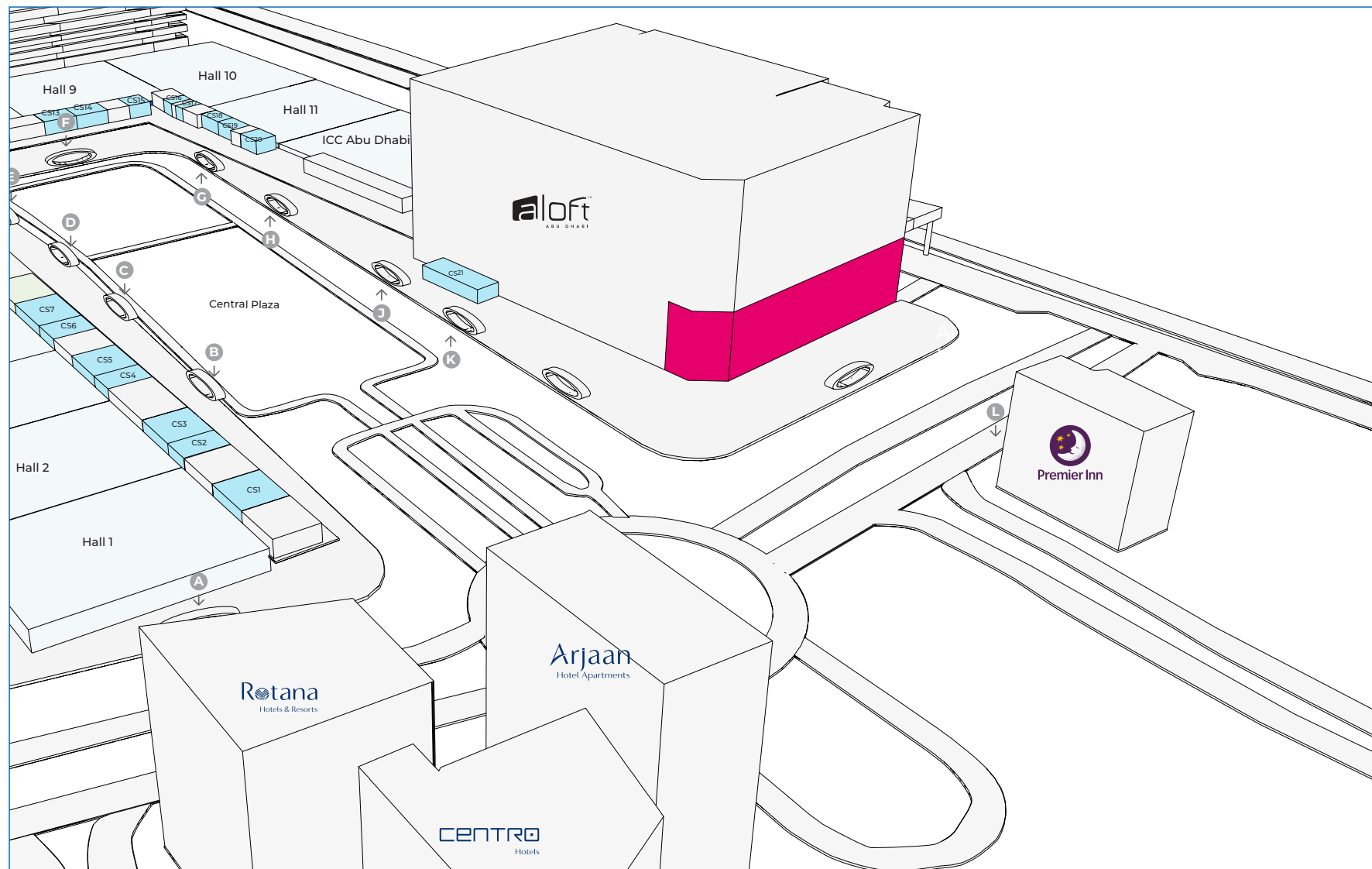

- › Luxurious 1,445 sqm (15,554 ft²) hall space can be used for weddings and banquets
- › 558 sqm (6006 ft²) pre-function hall
- › 150 sqm (1615 ft²) Majlis
- › Additional facilities include:
 - » Luxurious carpet throughout the main hall
 - » Modern and elegant wall design finishing
 - » Stage
 - » VIP Majlis chairs

AL MAA'RED HALL

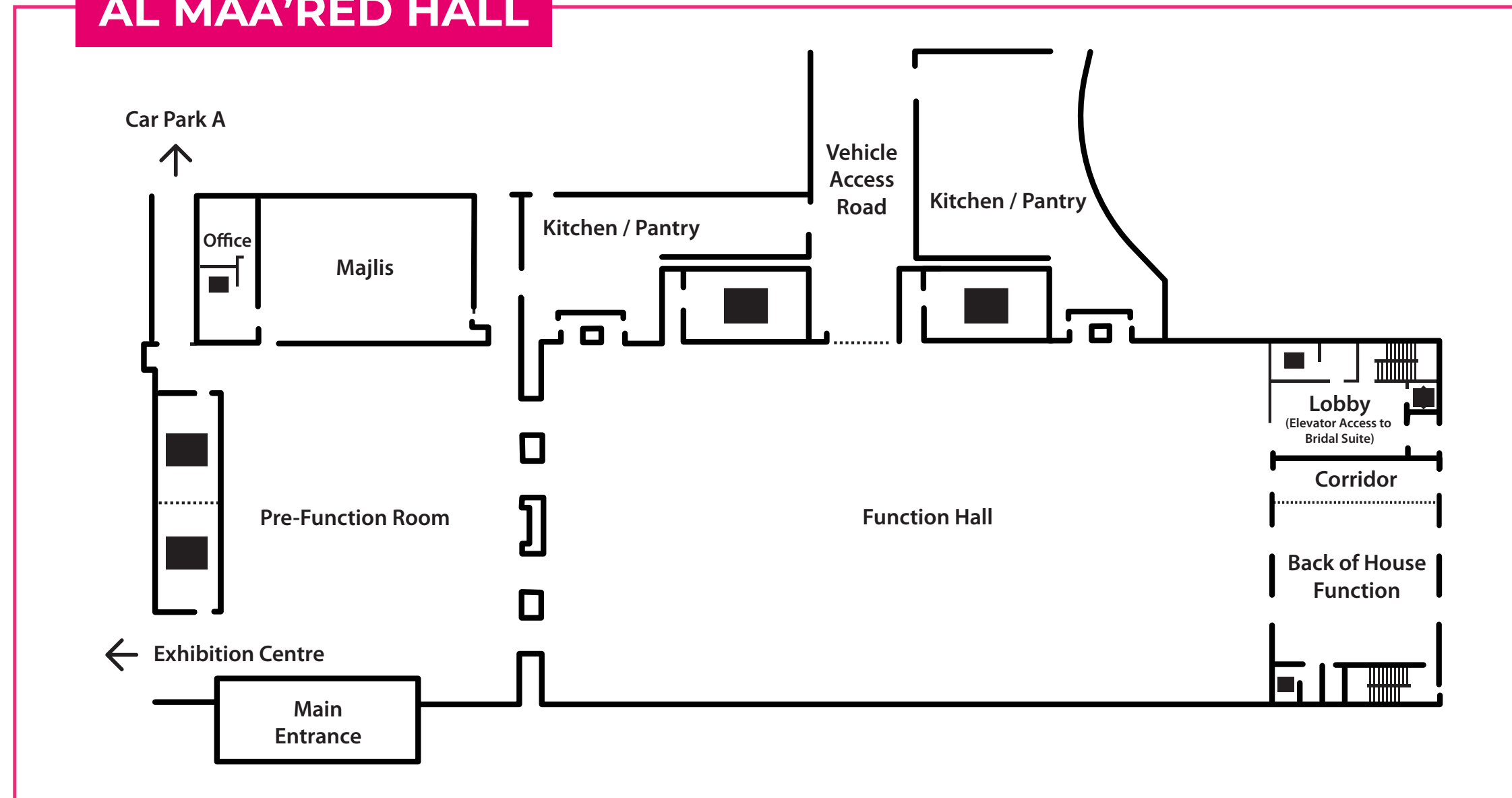

Hall Size	1,445 sqm (15,554 ft ²)
Pre-Function area	558 sqm (6006 ft ²)
Hall width	27m (88.6 ft ²)
Hall length	55m (180.5 ft ²)
Hall ceiling height	6m (19.69 ft ²)
Hall chandelier height	3.2m (10.5 ft ²)
Maximum stage width	20m (65.6 ft ²)
Special fittings	Al Maa'red Hall has 8 Chandeliers each is 3m (9.84 ft ²) in height
Additional Areas	Majlis, 2x kitchen Pantries, Band Area, 3x bathrooms, an Office

Capacities	Max Area
Theatre Style	1394
Classroom	720
Banquet	750

Additional Information
3m (9.84 ft ²) main guest entrance gangway
2m (6.56 ft ²) catering access and perimeter gangways
3m (9.84 ft ²) extra return here gangway behind stage as an emergency exit passage
There are no roof rigging points in Al Maa'red Hall

AL MAA'RED HALL



CONFERENCE HALLS

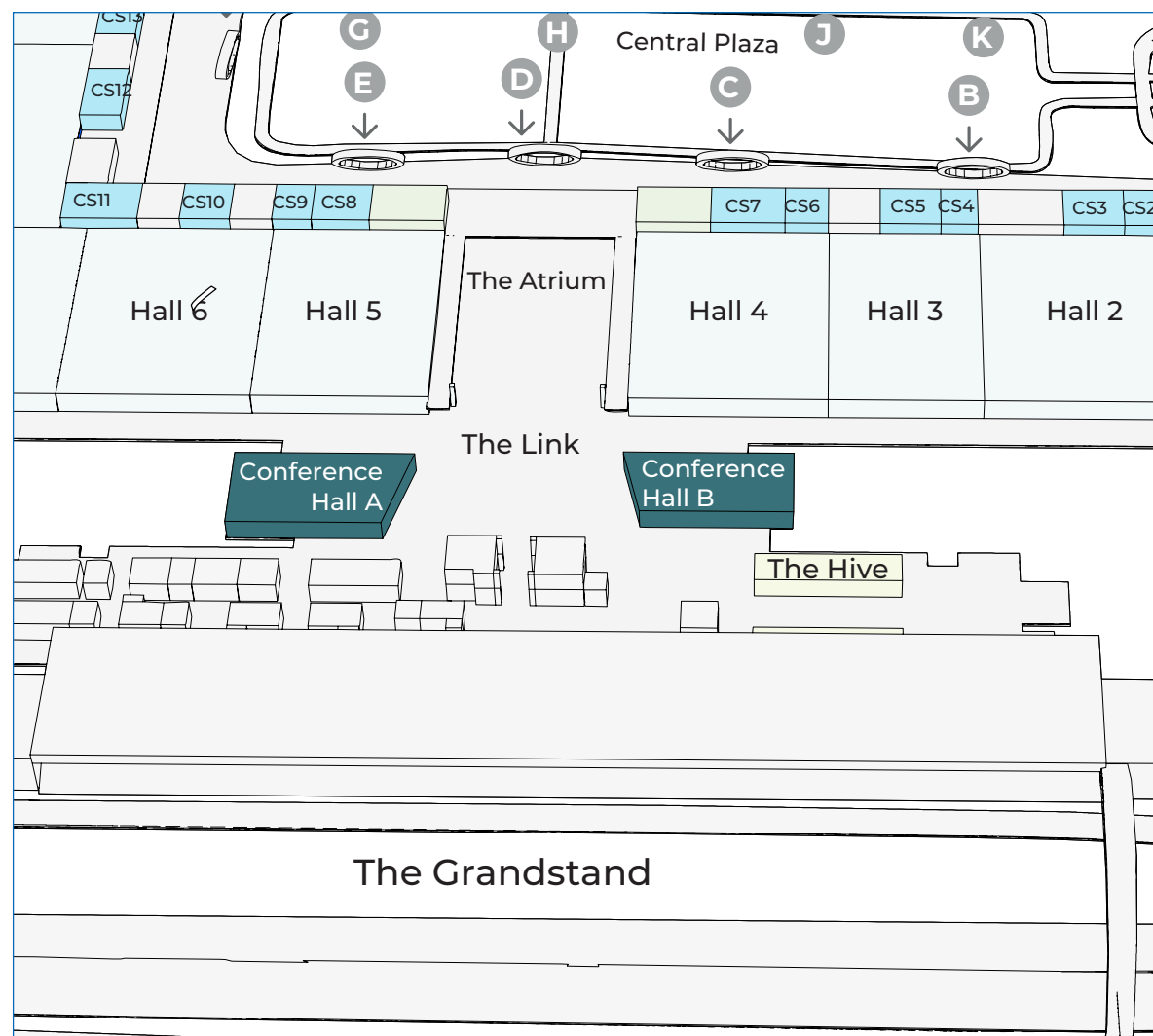

Conveniently accessible and stylishly decorated with a mixture of Arabian and modern fixtures, ADNEC Centre Abu Dhabi's Conference Halls are the perfect location for any conference, banquet or special event. With a maximum capacity of 1,600 guests, each conference hall can be subdivided into two, three and four smaller meeting rooms by fully retractable walls. The central 'Link' area can be used to combine both spaces and is suitable for catering and exhibition space.

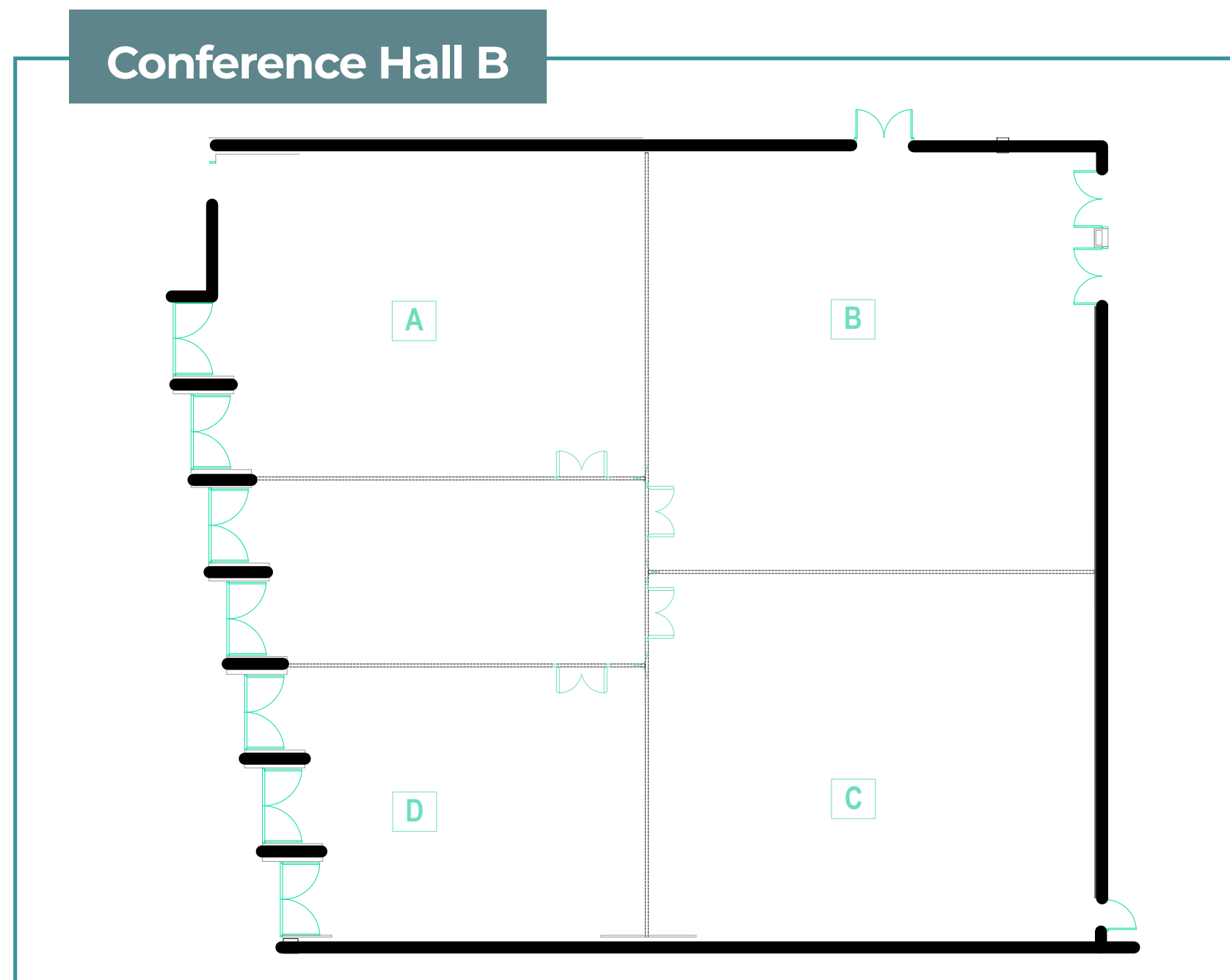
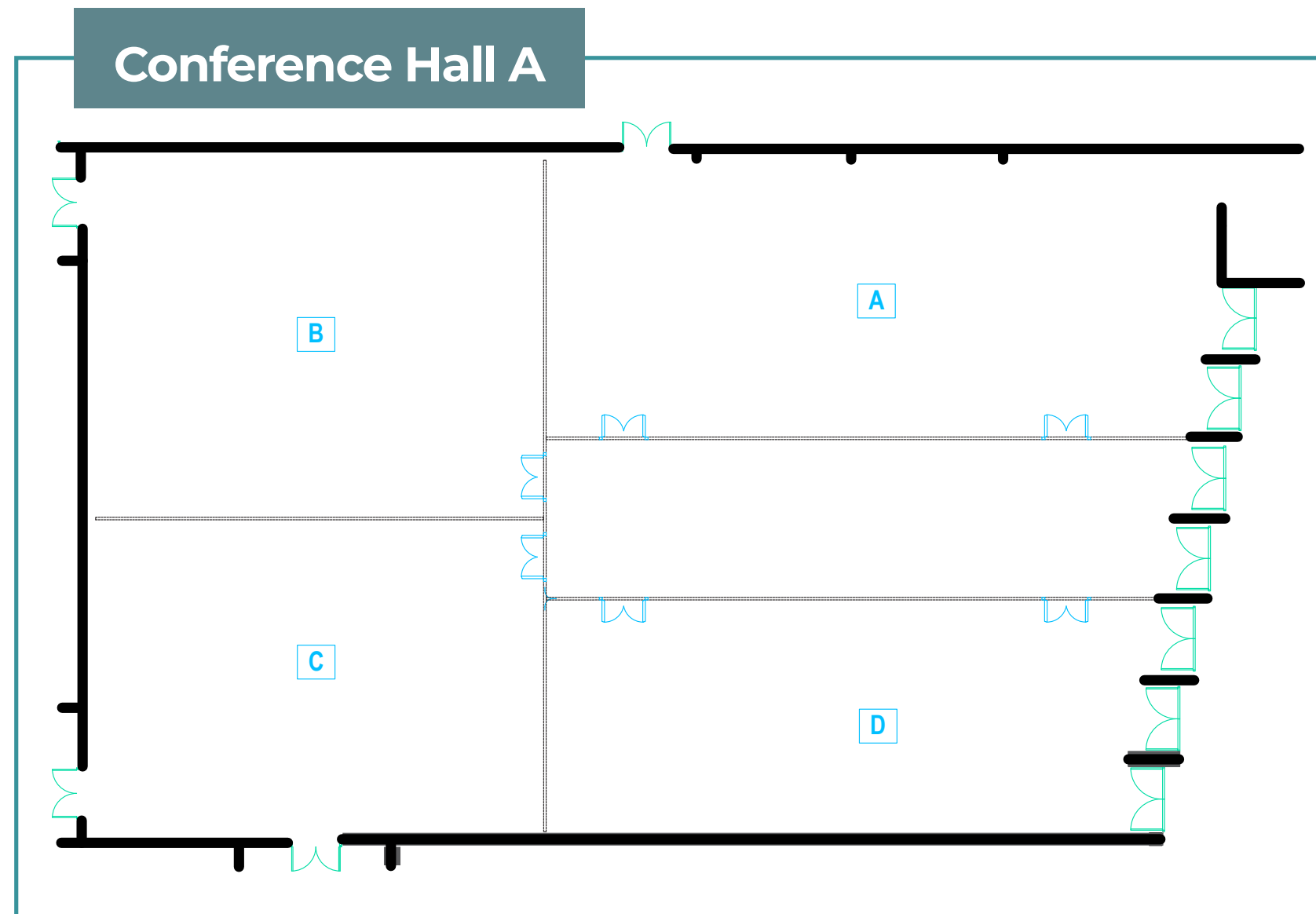

Dimensions

Floor Area 1,125 sqm (12,110 ft²)

Ceiling Height 7.5 m (24.6 ft²)

Capacities	Max Area	Part A	Part B	Part C	Part D
Area (sqm)	1,125	288	248	217	215
Area (ft ²)	12,110	3,100	2,670	2,336	2,314
Cocktail/ Reception	708	200	176	144	152
Theatre Style	1000	272	181	157	170
Classroom	522	114	105	87	96
Banquet	580	120	120	110	110

Dimensions

Floor Area 741 sqm (7,976 ft²)

Ceiling Height 7.5 m (24.6 ft²)

Capacities	Max Area	Part A	Part B	Part C	Part D
Area (sqm)	741	156	212	185	105
Area (ft ²)	7,976	1,679	2,282	1,991	1,130
Cocktail/ Reception	432	112	140	120	68
Theatre Style	600	108	142	122	47
Classroom	330	54	87	72	40
Banquet	370	60	90	90	40

Organiser Offices	Area (sqm)	Area (ft ²)
Conference A	50	539
Conference B	50	539

CONFERENCE HALLS



THE HIVE

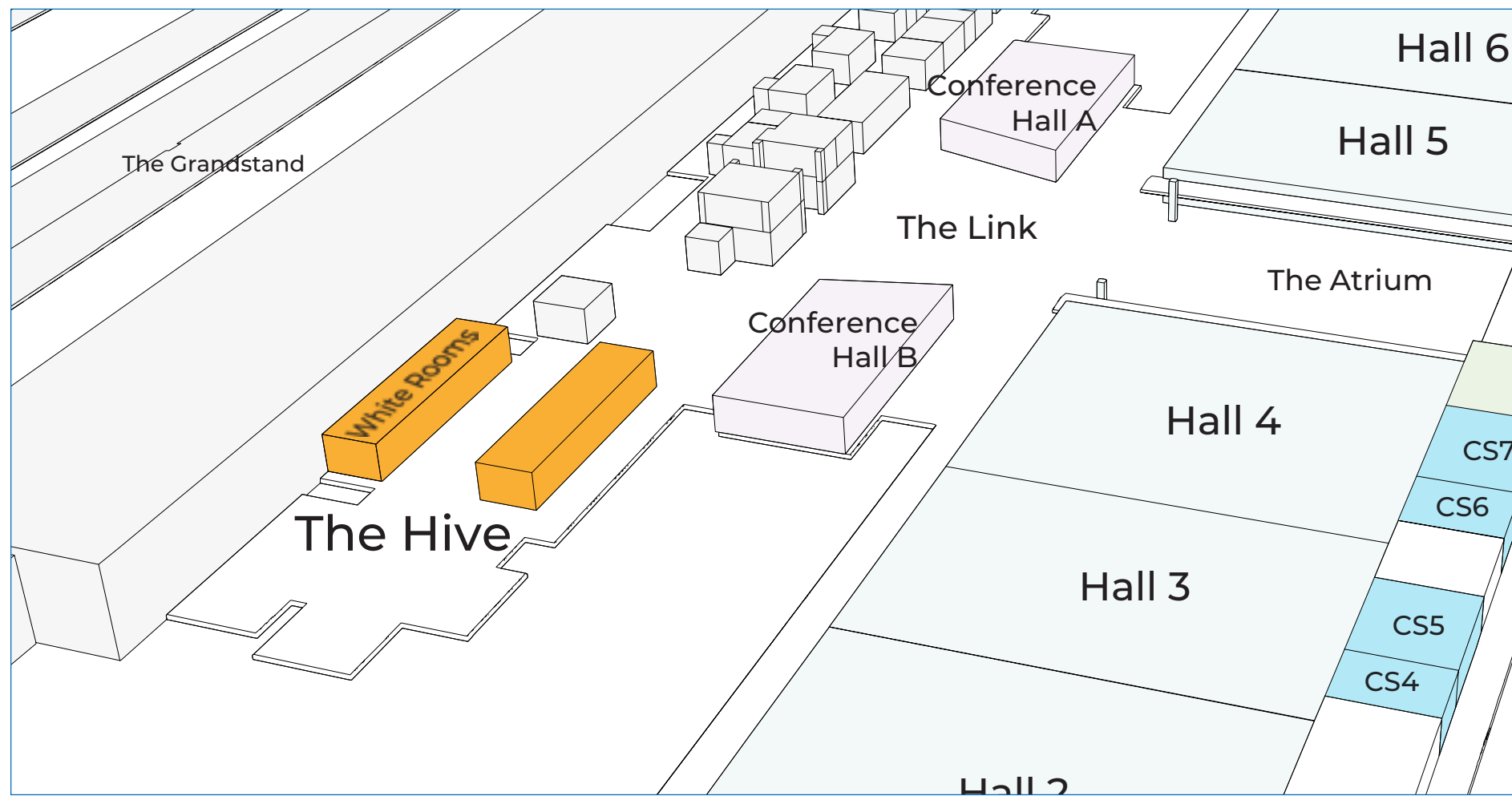

The Hive

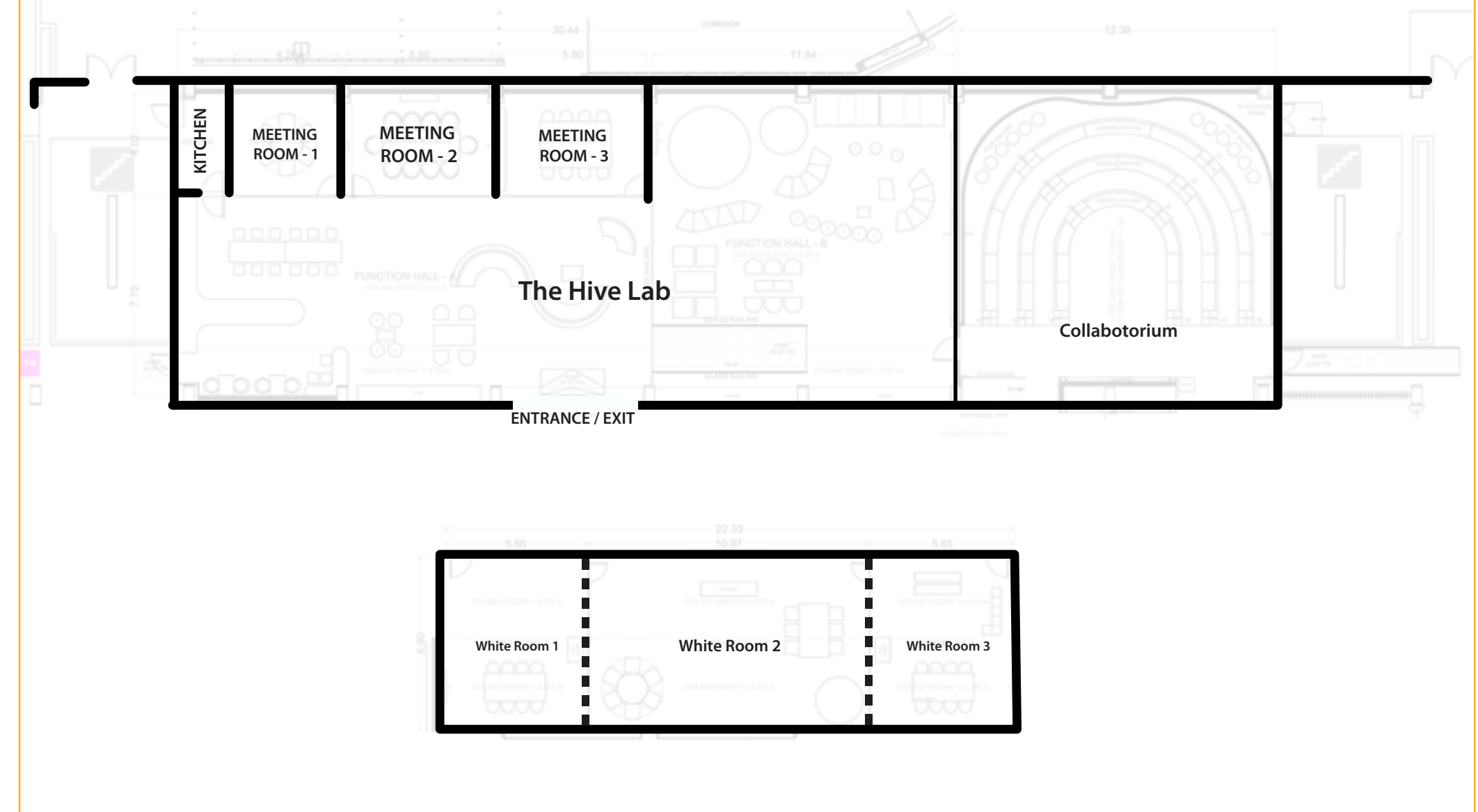

The Hive is an innovative meeting space that offers a creative space to connect, create, and collaborate. Spread over a self-contained 666 sqm (7,168.82 ft²) area, The Hive comprises an open plan space filled with flexible and modular furniture, an 80 seat Collabatorium, a grazing catering area and multiple individually themed private meeting rooms. Together with the white rooms across the corridor, the Hive is an environment designed to stimulate creativity, generate ideas and build connections.

Venue	Area (SQM)	Area (FT ²)	Ceiling Height
User Configurable Space	203.6	2191.5	Back: 5.1m (16.73 ft) Front: 2.76m (9.06 ft)
Lab Meeting Rooms (3)	63.2	680	Back: 4.87m (15.98 ft) Front: 2.47m (8.10 ft)
Collabatorium	157	1690	Ceiling Height: 3.98m (13.06 ft) Bottom of Chandelier: 3m (9.84 ft)
White Room 1	38.42	414	Back: 2.977m (9.77 ft) Front: 2.387m (7.83 ft)
White Room 2	74.59	803	Back: 2.977m (9.77 ft) Front: 2.387m (7.83 ft)
White Room 3	38.42	414	Back: 2.977m (9.77 ft) Front: 2.387m (7.83 ft)

THE HIVE



CAPITAL SUITES

Meeting Rooms

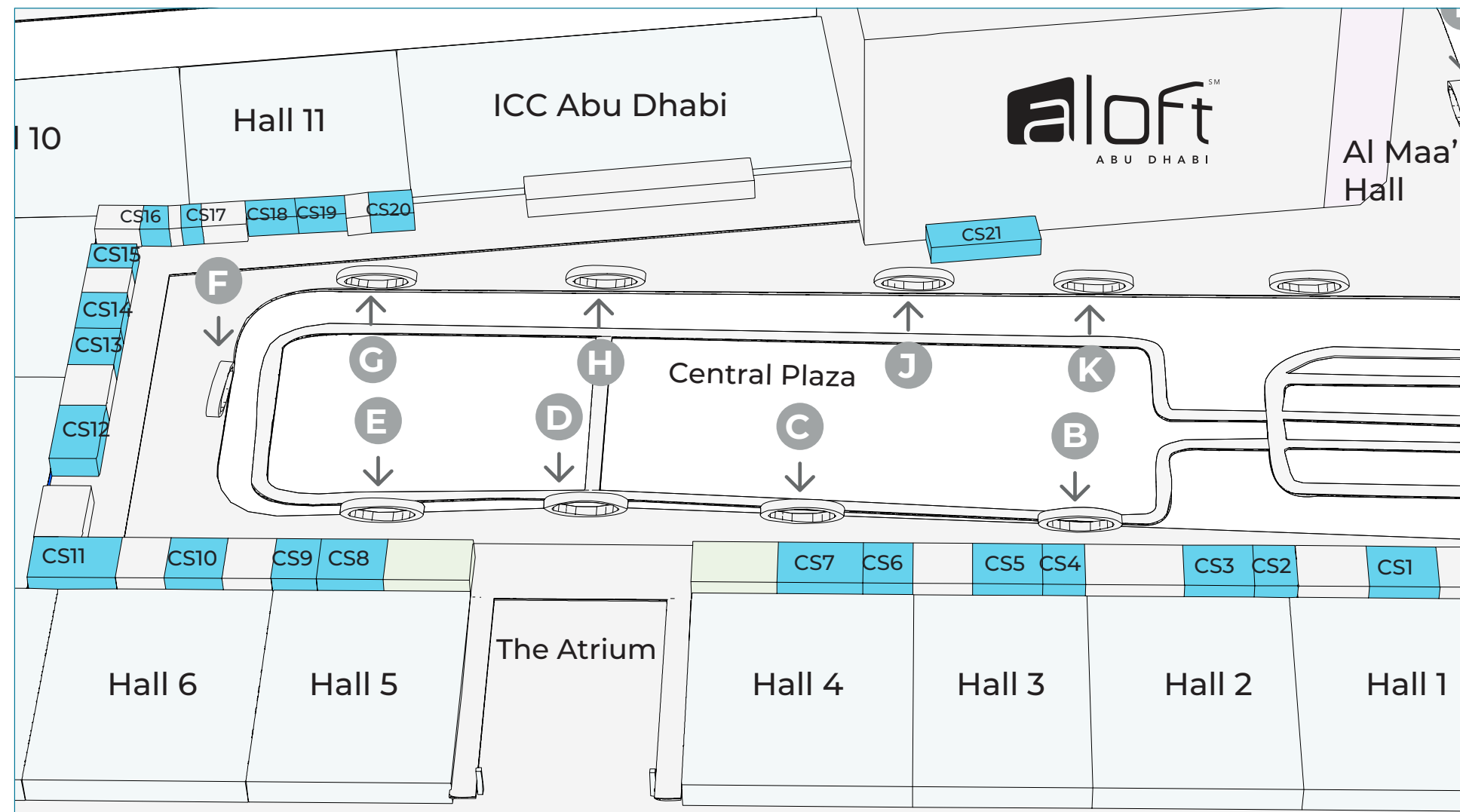

- › 21 meeting rooms
- › Capacities of 20 to 240 delegates
- › Located on the mezzanine floor of ADNEC Centre Abu Dhabi
- › Easy access including for those with special needs
- › Can host a range of meetings, functions and smaller conferences
- › Larger Capital Suites are equipped with interconnected kitchen facilities

TYPICAL SMALL MEETING ROOM

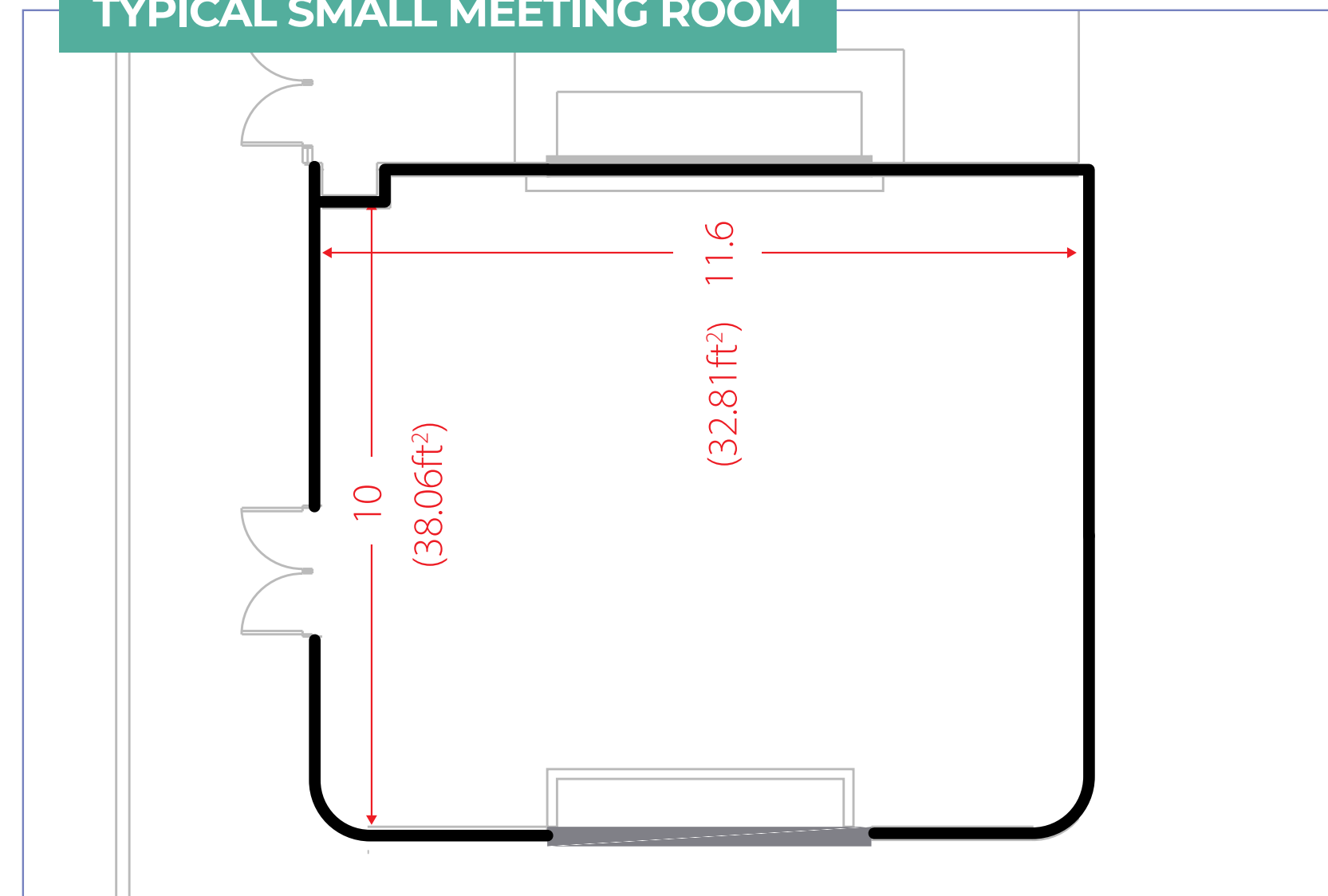

TYPICAL LARGE MEETING ROOM

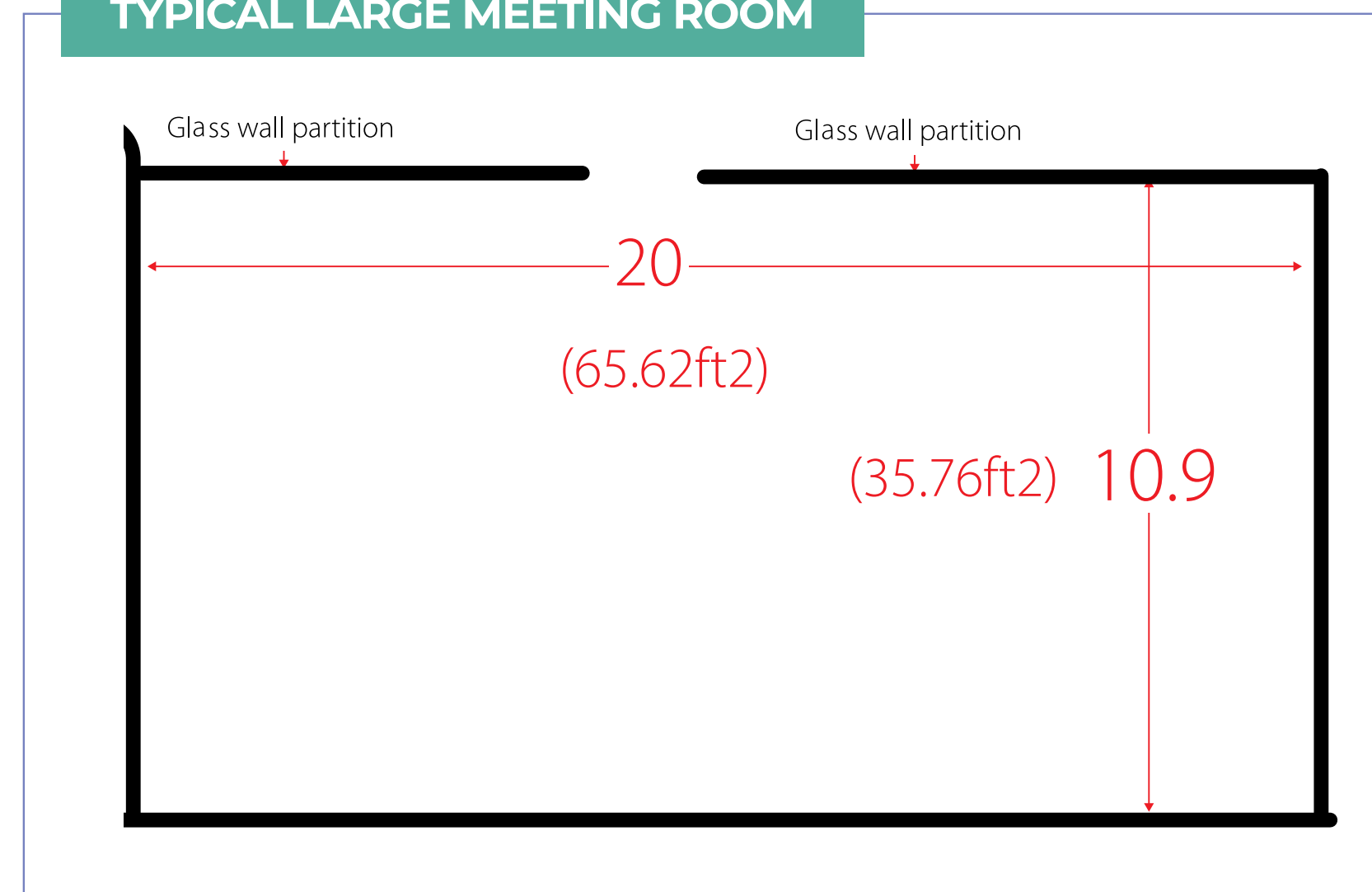

CAPITAL SUITES

Meeting Rooms

Capital Suite Dimensions and Capacities

CS	Area (sqm)	Area (ft ²)	Length (mtr)	Length (ft)	Width (mtr)	Width (ft)	Height (mtr)	Height (ft)	Capacity					
									U-shaped	Boardroom	Classroom	Theatre	Cocktail	Banquet
1	214	2,303.50	20	65.62	10.9	35.76	3.1	10.17	59	54	108	170	180	120
2	110	1,184.04	10	32.81	11.6	38.06	3.1	10.17	32	30	45	70	80	50
3	169	1,819.12	15.7	51.51	11	36.09	3.1	10.17	47	42	84	140	132	90
4	111	1,194.80	10	32.81	11.7	38.39	3.1	10.17	32	30	45	70	80	50
5	233	2,508.01	21.7	71.20	10.9	35.76	3.1	10.17	65	60	120	196	200	140
6	110	1,184.04	10.1	33.14	11.7	38.39	3.16	10.37	32	30	45	70	80	50
7	228	2,454.19	21.5	70.54	10.9	35.76	3.16	10.37	65	54	108	196	180	140
8	166	1,786.82	15.7	51.51	10.9	35.76	3.16	10.37	47	36	84	130	140	90
9	108	1,162.51	9.8	32.15	11.5	37.73	3.15	10.34	32	30	45	73	80	60
10	170	1,829.88	15.6	51.18	10.9	35.76	3.15	10.34	47	42	84	140	140	90
11A	47	505.91	7.45	24.44	6.43	21.10	3.15	10.34	15	12	18	40	36	20
11B	46	495.14	8.9	29.20	5.06	16.60	3.15	10.34	21	18	24	33	32	20
11D	35	376.74	7.12	23.36	4.94	16.21	3.15	10.34	15	12	18	27	24	20
12A	56	602.78	10.3	33.79	5.91	19.39	2.79	9.15	21	18	24	39	48	20
12B	56	602.78	10.3	33.79	5.66	18.57	2.79	9.15	21	18	24	39	48	20
13	180	1,937.52	16.6	54.46	11	36.09	2.8	9.19	53	42	96	140	132	110
14	181	1,948.28	16.65	54.63	11.03	36.19	2.8	9.19	53	42	96	140	132	100
15	112	1,205.57	10.01	32.84	11.7	38.39	2.8	9.19	32	30	45	50	50	50
16	124	1,334.74	11.12	36.48	11.9	39.04	2.8	9.19	35	24	60	84	96	70
17	77	828.83	11.7	38.39	7	22.97	2.8	9.19	27	30	30	50	40	30
18	97	1,044.11	8.8	28.87	11.1	36.42	4	13.12	32	24	45	50	50	50
19	170	1,829.88	15.3	50.20	11.7	38.39	2.79	9.15	47	42	84	145	136	100
20	115	1,237.86	10.1	33.14	11.3	37.08	2.8	9.19	32	30	50	50	50	50
21A	99	1,065.64	12.13	39.80	8.51	27.92	3.7	12.14	26	24	36	50	28	40
21B	96	1,033.34	12.13	39.80	8.14	26.71	3.7	12.14	26	24	36	50	28	40
21C	101	1,087.16	12.13	39.80	8.63	28.32	3.7	12.14	26	24	36	65	28	40
21A + 21B	195	2,098.98	12.13	39.80	16.65	54.63	3.7	12.14	44	36	90	145	56	60
21B + 21C	197	2,120.51	12.13	39.80	16.77	55.02	3.7	12.14	44	36	90	145	56	60
21A + 21B + 21C	296	3,186.14	12.13	39.80	25.25	82.85	3.7	12.14	74	66	138	247	84	100

ADNEC CENTRE ABU DHABI GRANDSTAND

ADNEC Centre Abu Dhabi is one of a select group of venues around the world capable of staging major indoor, outdoor and marine events simultaneously.

The grandstand area is equally ideal for viewing action on the marina, and demonstrations in front of the grandstand area.

Space	Area (SQM)	Area (FT ²)	Seating Capacity
Far West Side Area	80	861	561
West Side Area	2,476	26,651	2,476
Middle Area	180	1937.5	180
East Side Area	1,913	20,591	1,913
Far East Side Area	561	6,038	561

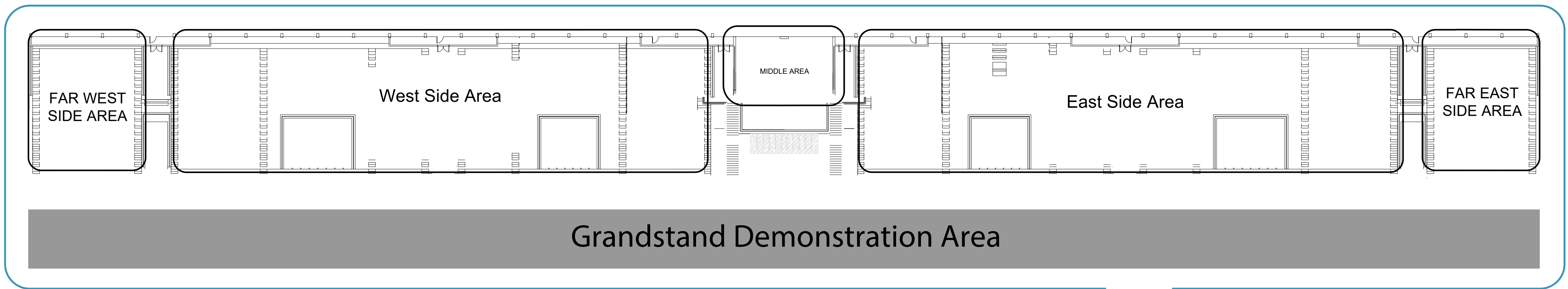

ADNEC CENTRE ABU DHABI GRANDSTAND



A World-Class Venue for World-Class Events



adnec centre

العين مركز أدنيك العين



adnec centre

مركز أدنيك العين al ain

ADNEC Centre Al Ain is only 80 minutes away from the rapidly expanding Zayed International Airport, 15 minutes from Al Ain International Airport and 75 minutes from Dubai International Airport. In the heart of this historic, UNESCO recognised city, it is ideally situated close to both the Municipality District and the bustling Al Jimi Mall.

It is the perfect venue to host exhibitions, conferences, weddings as well as special events.

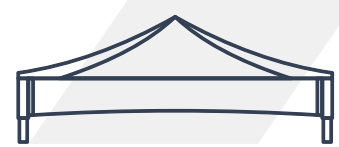

**Interconnected
column-free
space, expandable
to include link area**



Partitionable Halls

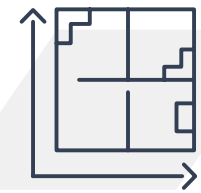

**2 event halls,
expandable to
include link area**



**7 Mid-range
conference &
meeting rooms**



**+11,000 Delegates
conference scale**





Click to Explore our space

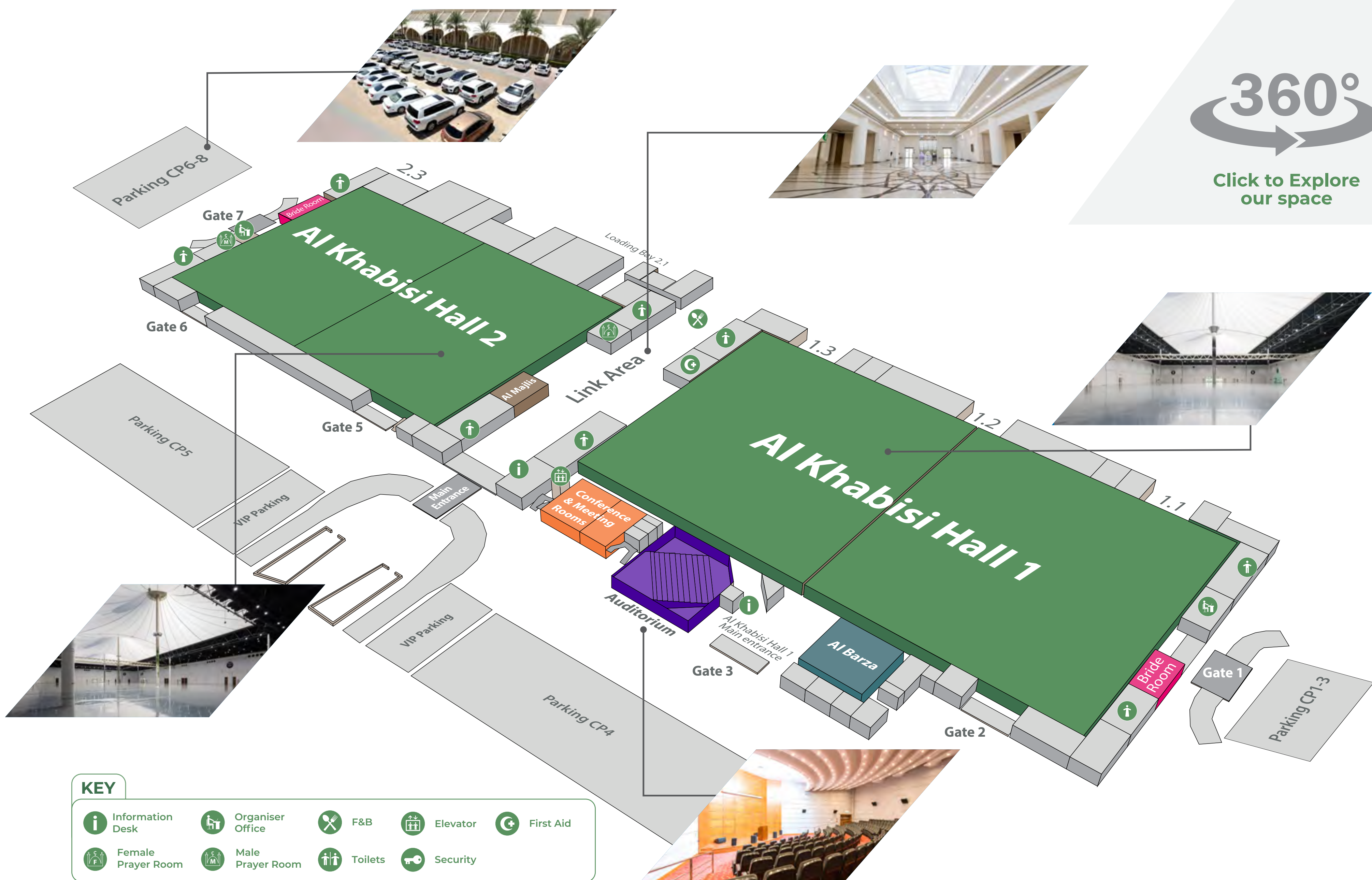

ADNEC CENTRE AL AIN

AL KHABISI HALL 2

Total Hall size	5,310sqm (57,157 ft ²)
Hall Dimensions	Width 59.4m, Length 89.4m (W 194.9 x L 293.3 ft)
Ceilling Height	9.974m (32.73 ft)
Entrance door	3 doors

• Operable walls can divide the hall to 2 equal section.

AL KHABISI HALL 1

Total Hall size	6,498sqm (69,944 ft ²)
Hall Dimensions	Width 59.4m, Length 109.4m (W 194.9 x L 358.9 ft)
Ceilling Height	9.974m (32.73 ft)
Entrance door	3 doors

• Operable walls can divide the hall to 2 equal section.

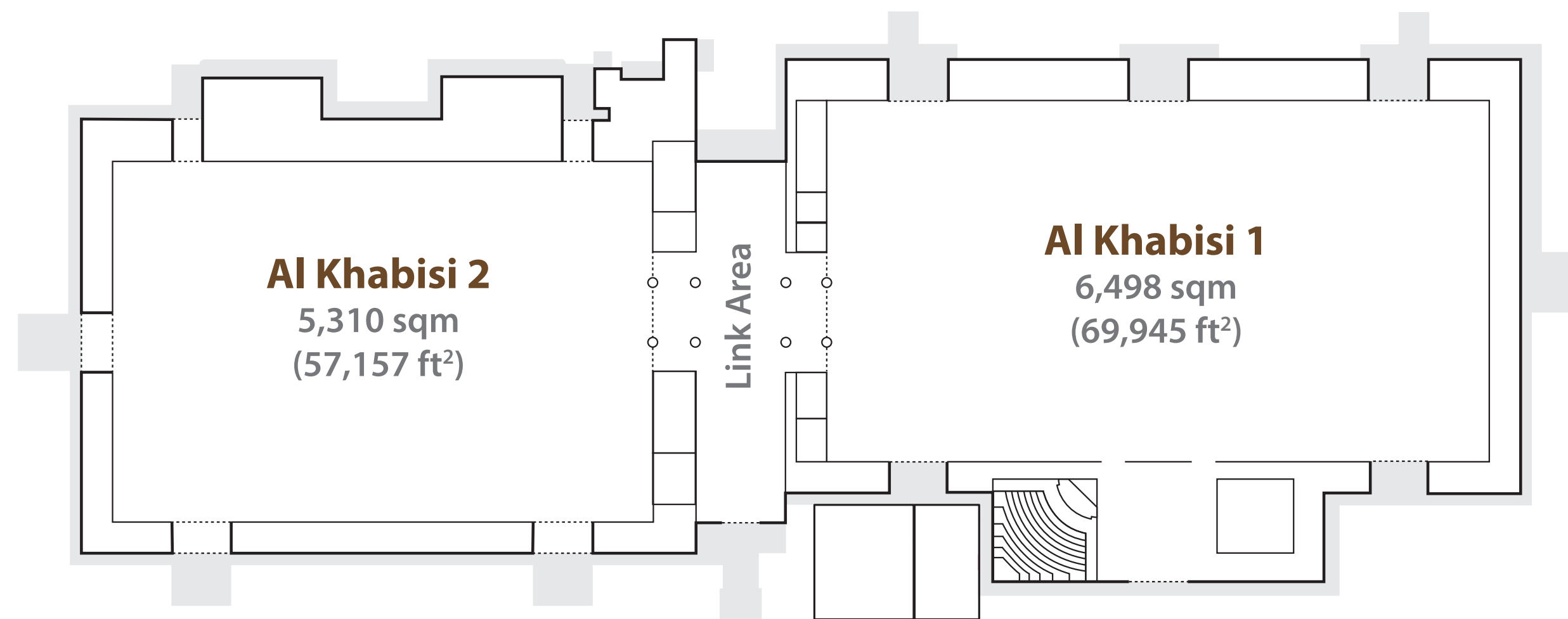

The Link Area

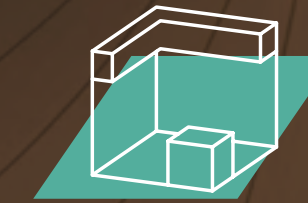

Flexible area, can be used as entrance, registration or catering area



Total size: 900 sqm (9687.60 ft²)

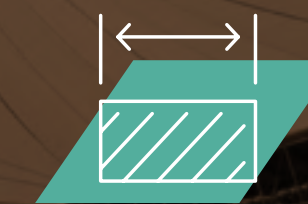

Connects Al Khabisi 1 and Al Khabisi 2

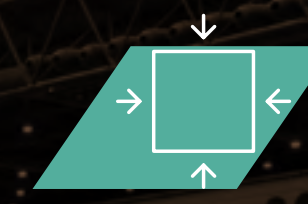

Two entrance doors and one main entrance to each hall

Auditorium



Theatre style seating for 242 delegates



Facilities include stage, A/V suite and conferencing equipment

Break Room

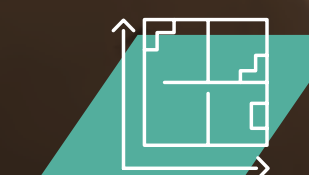

Total room size: 150sqm (1,615 ft²)



Suited to host VIPs or as additional room for weddings

ROOM CAPACITY SET UP

Area	Dimension	Floor Area	Majlis	Banquet	Cabaret	Classroom	Theatre	U-Shape	Board
Majlis Room	9.75 x 6.80m (31.99 x 22.31ft)	64.9 sqm (698.58 ft ²)	25	20	16	24	48	24	30
VIP Hall	12.15 x 12.15m (39.86 x 39.86ft)	147.6 sqm (1588.7 ft ²)	47	60	48	75	144	36	48

Conference Rooms	Dimension	Floor Area	Banquet	Cabaret	Classroom	Theatre	U-Shape	Board
CR 1	11.40 x 9.89 (37.4 x 32.45 ft)	112.7 (1213.1 ft ²)	50	40	60	108	30	42
CR 2	11.40 x 6.42 (37.4 x 21.06 ft)	73 (785.77 ft ²)	30	24	30	54	18	30
All Rooms (No Partition)	11.40 x 16.40 (37.40 x 53.81 ft)	186.96 (2012.44 ft ²)	80	64	103	197	48	60

Meeting Rooms	Dimension	Floor Area	Banquet	Cabaret	Classroom	Theatre	U-Shape	Board
MR 1	5.52 x 7.38 (18.11 x 24.21 ft)	40.7 (438.09 ft ²)	20	16	18	35	15	18
MR 2	5.42 x 7.38 (17.78 x 24.21 ft)	40 (430.5 ft ²)	20	16	18	35	15	18
MR 3	5.38 x 7.38 (17.65 x 24.21 ft)	39.7 (427.33 ft ²)	20	16	18	35	15	18
All Rooms (No Partition)	16.52 x 7.38 (54.20 x 24.21 ft)	121.91 (1312.13 ft ²)	60	48	63	132	42	48



THE MOST ELEGANT VENUE IN THE OASIS CITY



MULTI-AWARD WINNING VENUE & SERVICES



Best Sustainable Business Model, Bronze Award, Capital Catering
Gulf Sustainability Awards

Best Water & Waste Management, Gold Award, Capital Catering
Gulf Sustainability Awards

Outstanding Brand Activation Event, Capital 360
MESE Awards

C&IT Awards
C&IT Awards, Best International Venue

Best Venue
Middle East Event Awards (MESE)



Transform Awards
ADNEC Group 'Best Brand Development Project to Reflect a Change of Mission, Values or Positioning'- SILVER

Transform Awards
ADNEC Group 'Best Brand Evolution (Corporate)' - BRONZE

Transform Awards
Capital Catering + Services - Best Visual Identity from the Professional Services Sector' category - GOLD

Transform Awards
Capital Catering + Services 'Best Brand Evolution (Business)' category - BRONZE



Best Employer of the Year
Middle East Event Awards (MESE)

Excellence in Kitchen/Food Safety: Capital Hospitality
Middle East Cleaning, Hygiene and Facilities (MECHF)

UFI Human Resources Award Winner 2021

ICCA Marketing Award Outstanding Recognition
Research and Rationale



Middle East Event Awards 2020
Best Employer

Middle East Event Awards 2020
Best Association/Corporate Meeting, World Urban Forum 10

Exhibition News Awards
Best International Venue



AIPC Innovation Award
Event Catering Team of the Year Caterer Middle East

Wireless Implementation of the Year
Award at the Network Middle East (NME) Innovation Awards



Best Venue
MESE Awards 2018



Sustainability Award
MEES Awards 2017

Sustainability Award
AEO Excellence Awards



Best Meetings and Conference Centre
Business Destinations



32 International Awards



WHAT OUR CLIENTS SAY

dmg::events

Chris Hudson
President dmG Events

"What makes great venue work is great leadership and ADNEC has that in abundance, it has great account managers and a comms team behind them that work extensively with organisers so it's not just a partnership where we buy a tenancy with a venue, it's a marriage."

**asembl.
group**

Gavin Farley
CEO of Assembl

"We knew this was the best place to bring this regional technology event and we haven't been let down. The partnership we have with ADNEC has been second-to-none. ADNEC has provided an end-to-end solution which made my team's lives easier. We can't wait to be back."

Hunter
Int'l Travel & Tourism LLC

Gino Wang
Hunter International
Travel and Tourism

"ADNEC Centre Abu Dhabi was a great choice due to the size of facility and their experience in facilitating events of this scale," he says. "We were delighted with the catering, as this was a vital element of the awards and gala dinner element. The end-client was very happy with the event and received excellent feedback from their employees. We are looking at working with the venue again in the near future for a different client."

RX

Vasyl Zhygalo
Managing Director RX
Middle East

"Our partnership with ADNEC has been very fruitful, at Reed Exhibitions we are passionate about the customer journey and we have found the perfect

**WORLD
ENERGY
COUNCIL**

**Dr Angela
Wilkinson**
Secretary General and
CEO at the World
Energy Council

"We were delighted to work with the team at ADNEC to deliver a truly memorable 24th World Energy Congress and cement its role in promoting an inclusive global energy agenda and enabling forward-looking, action-orientated dialogue."

UN HABITAT
FOR A BETTER URBAN FUTURE

**Madame
Maimunah Sharif**
Executive Director,
UN-Habitat

"ADNEC were not only able to project manage a complex event but also to ensure that all stakeholders expectations were met throughout the process. The ADNEC Services is one of the very best event teams that UN-Habitat had the pleasure to work with over the years and we look forward to the next opportunity to work together again"

dmg::events

**Salman Abou
Hamzeh**
Senior Vice President at
dmG events

"Our partnership with ADNEC was brilliant. Abu Dhabi Global Healthcare Week was a great success. Everybody was happy, from stakeholders, visitors, exhibitors and delegates. We couldn't do this without ADNEC's support, particularly the team and all the services that ADNEC provides. Thank you very much and we are looking forward to a bigger event next year."

ICRA
CONGRESS
ABU DHABI

Josée Kirps,
President-Elect of the
International Council
on Archives

"It is the first time this congress is in the Middle-East and I would recommend the ADNEC Team and the venue, the team are experienced so, it was fantastic for us to be here, and we are very grateful to Abu Dhabi and we are very grateful to ADNEC."



A DIVERSE DESTINATION OF DISTINCTION

Abu Dhabi is a land of contrasts. You will find a modern, cosmopolitan capital city of dramatic skyscrapers surrounded by turquoise waters and white sandy beaches, the serenity of an ancient UNESCO World Heritage oasis settlement, dramatic deserts as well as culture and attractions. The Emirate basks in year-round sunshine with little rainfall and superb temperatures (October-May) ideal for outdoor events.

A MEMORABLE STAY



Sheikh Zayed Grand Mosque



Ferrari World



Yas Waterworld



Warner Bros World



Louvre Abu Dhabi



Desert safari and dune bashing

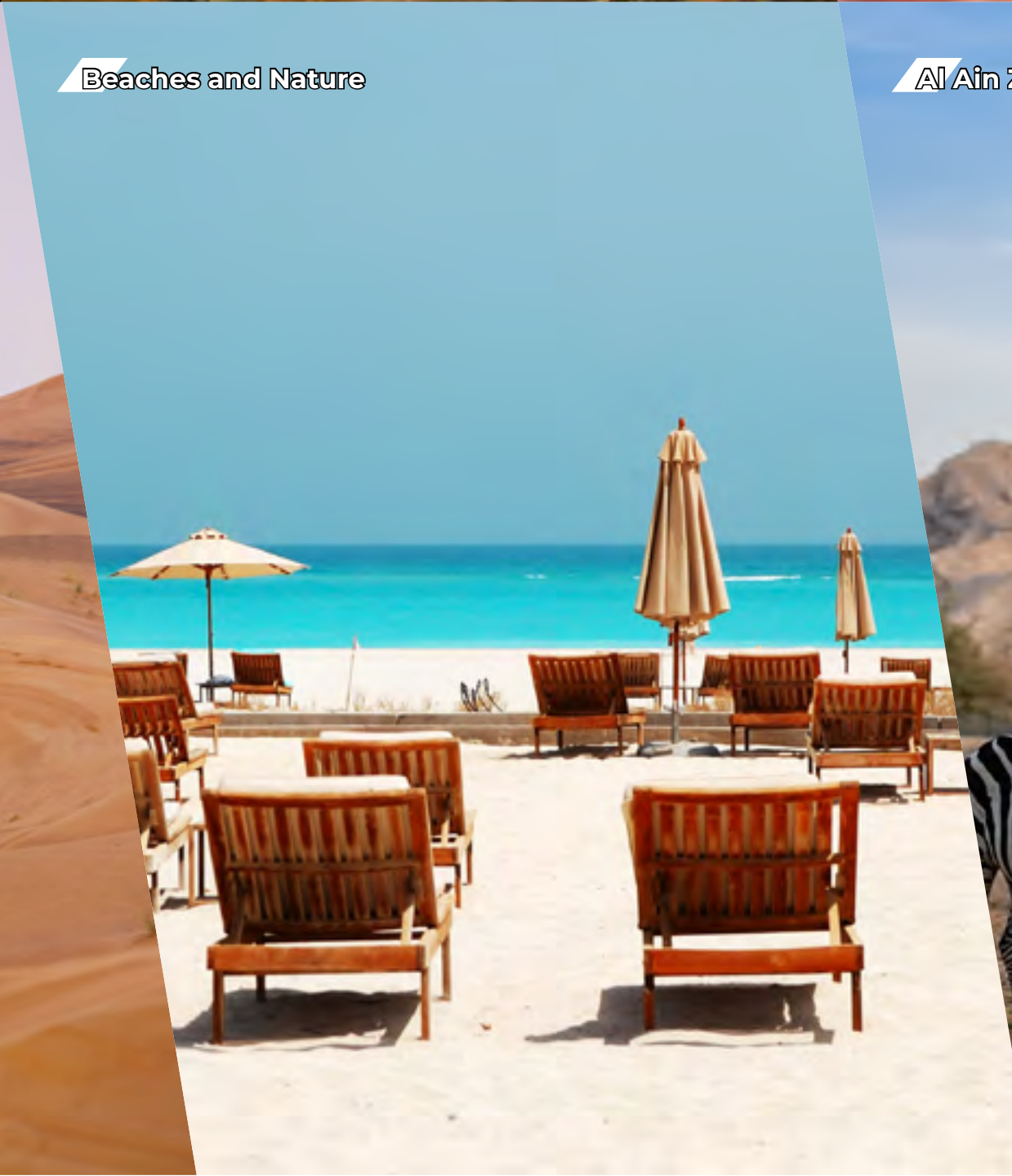

Beaches and Nature



Al Ain Zoo



Al Ain Oasis



Jebel Hafeet



@adnecad

adnec.ae

sales.enquiries@adnec.ae

